

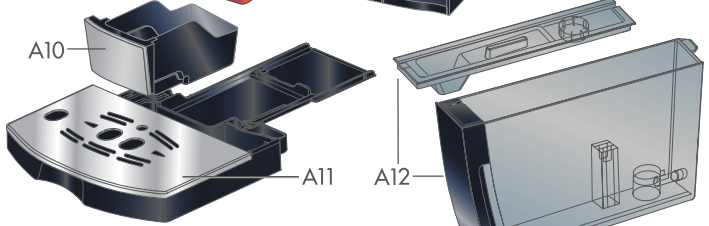

IN THE BOX

- A1. Grinding adjustment dial
- A2. Beans container
- A3. Pre-ground coffee funnel
- A4. Main switch
- A5. Infuser
- A6. Cup warmer shelf
- A7. Control panel
- A8. Hot water and steam nozzle
- A9. Coffee spout (adjustable height)
- A10. Coffee grounds container
- A11. Cup tray
- A12. Water tank with lid

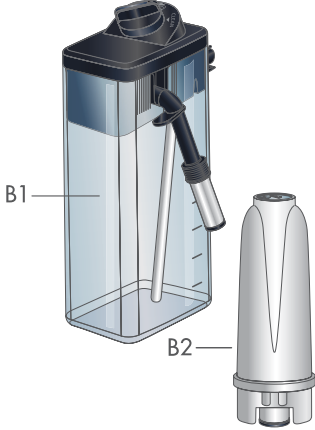
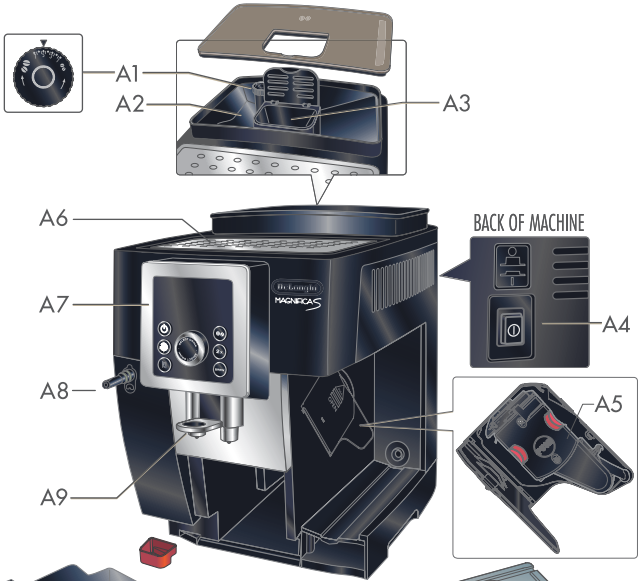

- B1. I.F.D. (Instant Frothing Dispenser) Carafe
- B2. Water filter
- B3. Measuring scoop
- B4. Hot water spout
- B5. Cleaning brush



Natural Descaler
100ml/3.4oz.



Get Started & Owner's
Instructions Booklets



MACHINE SET UP

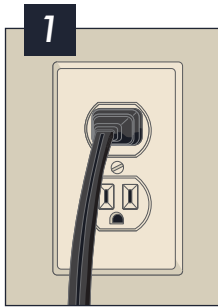

1 Plug into outlet

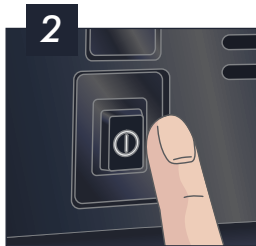

2 Push **ON** main switch, located on back of machine.

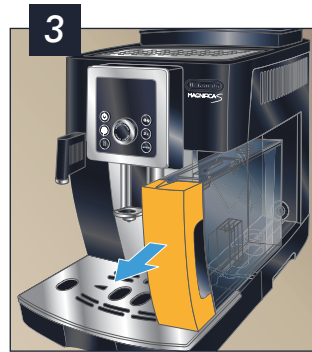

3 Remove and fill water tank, then replace.

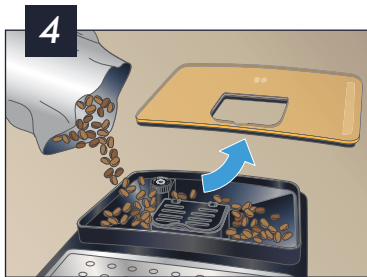

4 Fill coffee beans



5 Insert water spout and place a container underneath.



6 Press **OK** Button. The machine will prime. A little water will be released by the hot water spout. The machine will then switch it off automatically.



7 Press **ON/OFF** button to turn ON machine.

Machine is now ready to work!

See the **Get Started** booklet for further instructions.

Video available on www.youtube.com/delonghiusa

5713227031/01.15

ECAM23260