



5713232491/10.16

---

ECAM35X.35

BEAN TO CUP ESPRESSO  
AND CAPPUCCINO MACHINE

Instruction for Use

Instruction videos available at:  
<http://ecam35035.delonghi.com>



---

**DeLonghi**

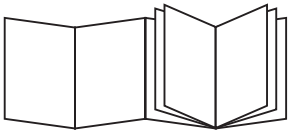

**B**

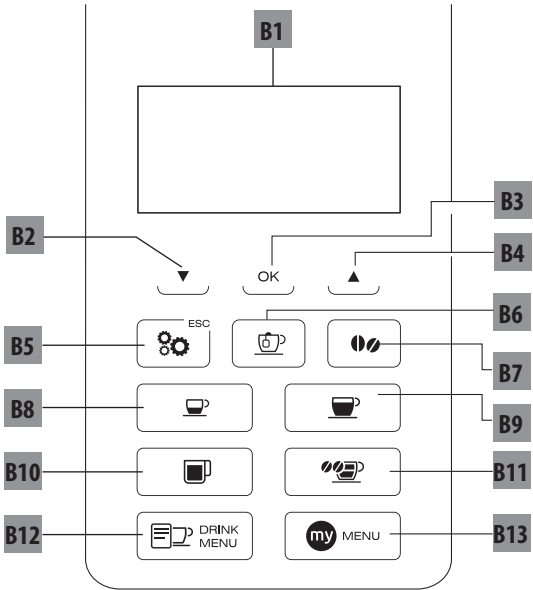

**C**

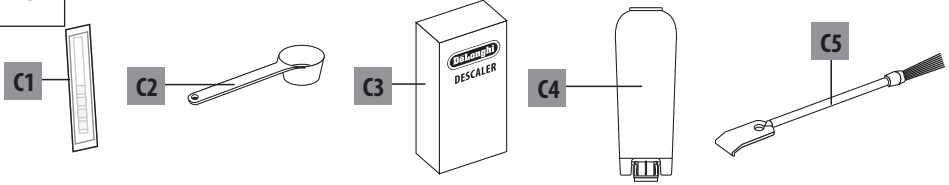

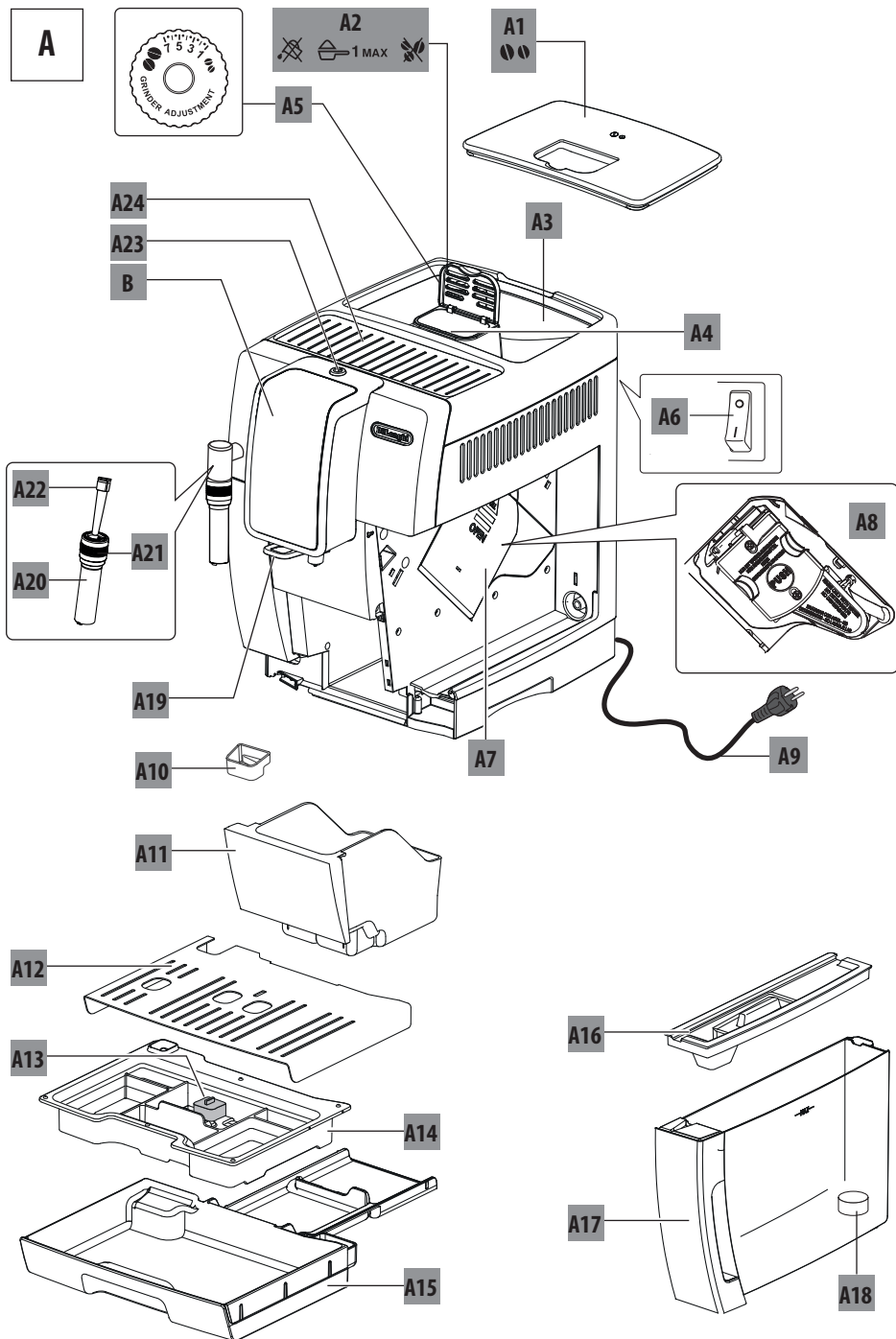

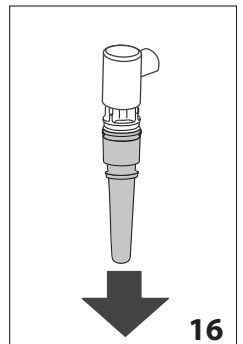
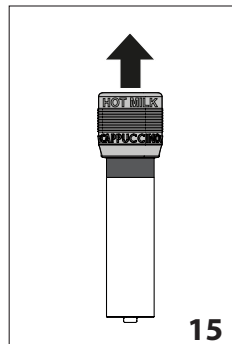
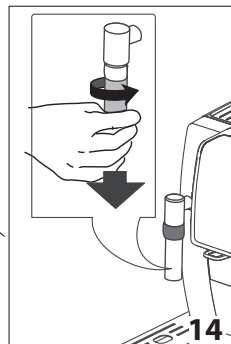
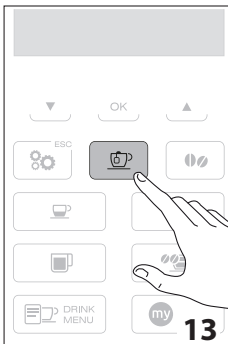
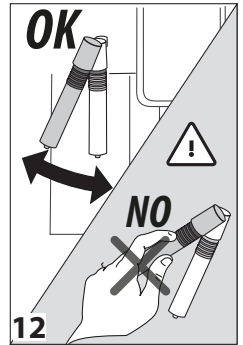
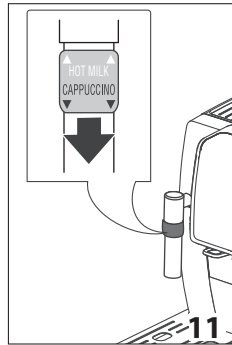
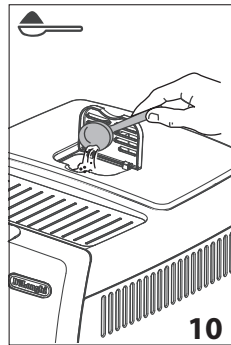
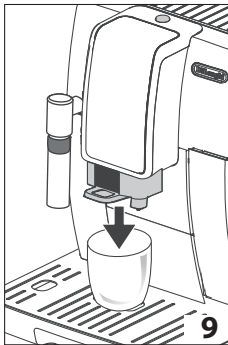
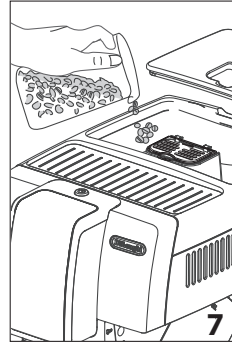
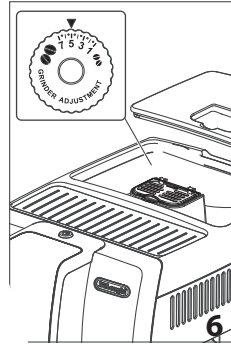
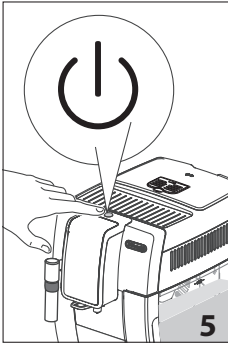
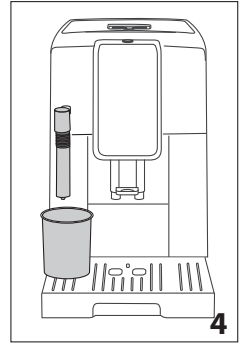
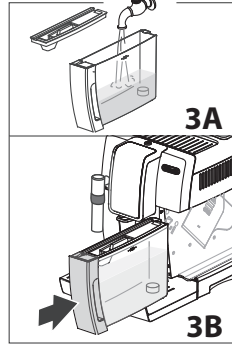
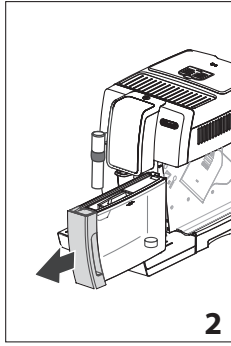
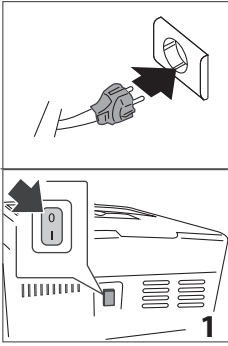

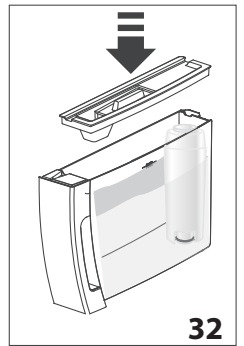
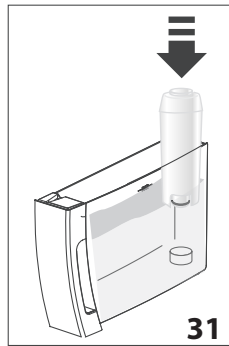
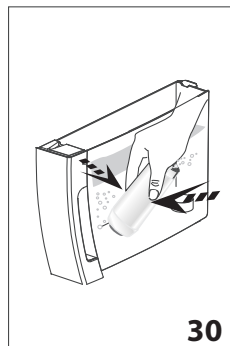
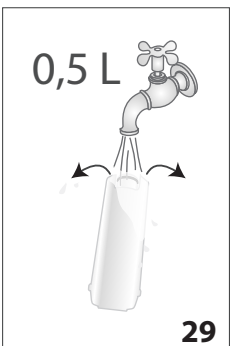
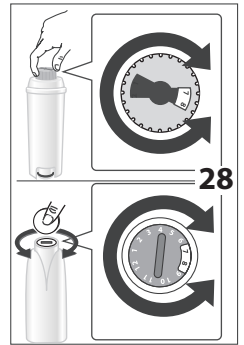
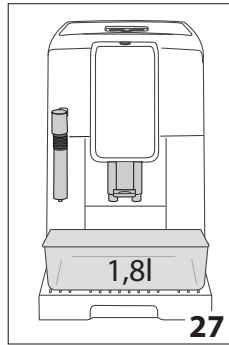
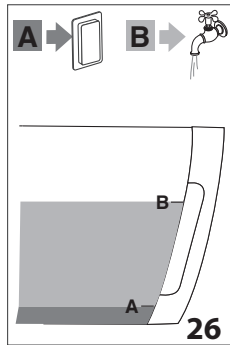
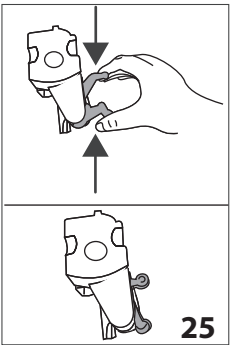
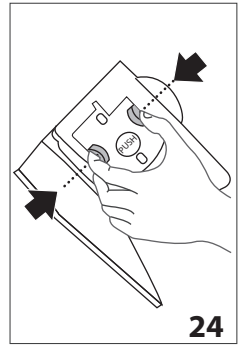
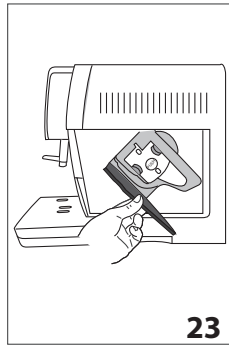
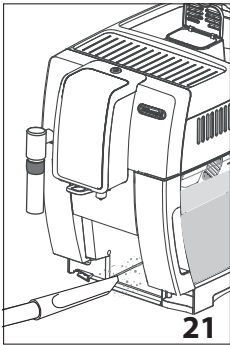
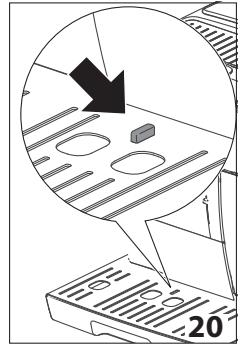
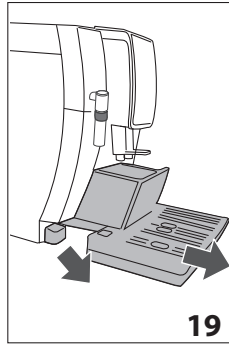
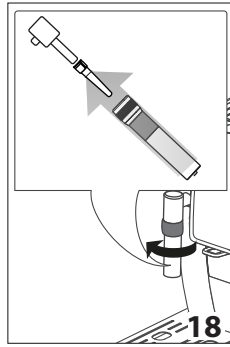
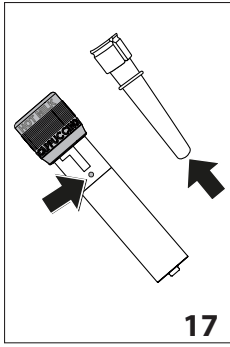

## CONTENTS

<b>1. FUNDAMENTAL SAFETY WARNINGS.....</b>	<b>7</b>
<b>2. SAFETY WARNINGS .....</b>	<b>8</b>
2.1 Symbols used in these instructions .....	8
2.2 Designated use.....	8
2.3 Instruction for Use.....	8
<b>3. INTRODUCTION.....</b>	<b>8</b>
3.1 Letters in brackets.....	8
3.2 Troubleshooting and repairs.....	8
<b>4. DESCRIPTION.....</b>	<b>9</b>
4.1 Description of the appliance .....	9
4.2 Description of the accessories.....	9
<b>5. BEFORE USE.....</b>	<b>9</b>
5.1 Checking the appliance .....	9
5.2 Installing the appliance.....	9
5.3 Connecting the appliance.....	9
5.4 Setting up the appliance .....	10
<b>6. TURNING THE APPLIANCE ON.....</b>	<b>10</b>
<b>7. TURNING THE APPLIANCE OFF .....</b>	<b>10</b>
<b>8. MENU SETTINGS .....</b>	<b>10</b>
8.1 Rinsing.....	11
8.2 Language.....	11
8.3 Maintenance .....	11
8.4 Program beverages .....	11
8.5 Program My beverages.....	11
8.6 General .....	11
8.7 Statistics.....	12
<b>9. MAKING COFFEE.....</b>	<b>12</b>
9.1 Adjusting the coffee mill .....	12
9.2 Tips for a hotter coffee.....	13
9.3 Making automatic recipes using coffee beans .	13
9.4 Temporarily varying the coffee aroma.....	13
9.5 Making coffee using pre-ground coffee.....	14
<b>10. MAKING CAPPUCCINO AND HOT MILK (NOT FROTHED) .....</b>	<b>14</b>
10.1 Making hot milk (not frothed).....	15
10.2 Cleaning the cappuccino maker after use....	15
<b>11. PROGRAMMING AND SELECTING.....</b>	<b>15</b>
<b>12. DELIVERING HOT WATER .....</b>	<b>15</b>
<b>13. CLEANING.....</b>	<b>16</b>
13.1 Cleaning the machine .....	16
13.2 Cleaning the machine's internal circuit .....	16
13.3 Cleaning the coffee grounds container.....	16
13.4 Cleaning the drip tray and condensate tray .	16
13.5 Cleaning the inside of the coffee machine...	16
13.6 Cleaning the water tank.....	16
13.7 Cleaning the coffee spouts .....	17
13.8 Cleaning the pre-ground coffee funnel .....	17
13.9 Cleaning the infuser .....	17
<b>14. DESCALING .....</b>	<b>17</b>
<b>15. SETTING WATER HARDNESS .....</b>	<b>18</b>
15.1 Measuring water hardness .....	18
15.2 Setting water hardness .....	18
<b>16. WATER SOFTENER FILTER .....</b>	<b>18</b>
16.1 Installing the filter .....	18
16.2 Replacing the filter.....	19
16.3 Removing the filter .....	19
<b>17. TECHNICAL DATA.....</b>	<b>19</b>
<b>19. DISPLAYED MESSAGES.....</b>	<b>20</b>
<b>18. DISPOSING OF THE APPLIANCE .....</b>	<b>20</b>
<b>20. TROUBLESHOOTING .....</b>	<b>22</b>
<b>21. ELECTRICAL REQUIREMENTS.....</b>	<b>23</b>

## 1. FUNDAMENTAL SAFETY WARNINGS

---

- The appliance is not intended for use by persons (including children) with reduced physical, sensory or mental capabilities, or lack of experience and knowledge, unless they have been given supervision or instruction concerning use of the appliance by a person responsible for their safety.
- Children should be supervised to ensure that they do not play with the appliance.
- Cleaning and user maintenance shall not be made by children without supervision.
- Never clean by immersing the appliance in water.
- This is an household appliance only. It is not intended to be used in: staff kitchen areas in shops, offices and other working environments; farm houses; by clients in hotels, motels and other residential type environments; bed and breakfast type environments.
- If the plug or cord is damaged, it must be replaced by Customer Services only to avoid all risk.

### FOR EUROPEAN MARKETS ONLY:

- This appliance can be used by children aged from 8 years and above if they have been given supervision or instruction concerning use of the appliance in a safe way and understand the hazards involved. User cleaning and maintenance shall not be made by children unless they are above 8 years old and supervised. Keep the appliance and power cord away from children under 8 years of age.
- Appliances can be used by persons with reduced physical, sensory or mental capabilities or lack of experience and knowledge if they are supervised or have been given instruction concerning use of the appliance in a safe way and if they understand the hazards involved.
- Children shall not play with the appliance.
- Always unplug the appliance when left unattended and before assembly, taking apart or cleaning.



Surfaces marked with this symbol become hot during use (the symbol is present in certain models only).



## 2. SAFETY WARNINGS

### 2.1 Symbols used in these instructions

Important warnings are identified by these symbols. It is vital to respect these warnings.



Failure to observe the warning may result in life threatening injury by electric shock.



Failure to observe the warning could result in injury or damage to the appliance.



Failure to observe the warning could result in scalds or burns.



This symbol identifies important advice or information for the user.



This is an electrical appliance and may cause electric shock.

You should therefore follow these safety warnings:

- Never touch the appliance with damp hands or feet.
- Never touch the plug with damp hands.
- Make sure the socket used is freely accessible at all times, enabling the appliance to be unplugged when necessary.
- Unplug directly from the plug only. Never pull the cord as you could damage it.
- To disconnect the appliance completely you must unplug it from the mains socket.
- If the appliance is faulty, do not attempt to repair. Turn it off, unplug from the mains socket and contact Customer Services.
- Before cleaning the appliance, turn it off, unplug from the mains socket and allow to cool.



Keep all packaging (plastic bags, polystyrene foam) away from children.



This appliance produces hot water and steam may form while it is in operation.

Avoid contact with splashes of water or hot steam.

When the appliance is in operation, the cup shelf could become very hot.

### 2.2 Designated use

This appliance is designed and made to prepare coffee and hot beverages.

Any other use is considered improper and thus dangerous. The manufacturer is not liable for damage deriving from improper use of the appliance.

### 2.3 Instruction for Use

Read this Instruction for Use carefully before using the appliance. Failure to follow this Instruction for Use may result in burns or damage to the appliance.

The manufacturer is not liable for damage deriving from failure to respect this Instruction for Use.



Keep these instructions for future use. If the appliance is passed to other persons, they must also be provided with this Instruction for Use.

## 3. INTRODUCTION

Thank you for choosing this bean to cup espresso and cappuccino machine.

We hope you enjoy using your new appliance. Take a few minutes to read this Instruction for Use. This will avoid all risks and damage to the appliance.

### 3.1 Letters in brackets

The letters in brackets refer to the legend in the description of the appliance on pages 2-3.

### 3.2 Troubleshooting and repairs

In the event of problems, first try and resolve them by reading the information given in sections "19. Displayed messages" and "20. Troubleshooting".

If this does not resolve the problem or you require further information, you should consult Customer Services by calling the number given on the annexed "Customer Service" sheet.

If your country is not among those listed on the sheet, call the number given in the guarantee. If repairs are required, contact De'Longhi Customer Services only. The addresses are given in the guarantee certificate provided with the machine.

## 4. DESCRIPTION

### 4.1 Description of the appliance



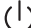

(page 3 - A)

- A1. Beans container lid
- A2. Pre-ground coffee funnel lid
- A3. Beans container
- A4. Pre-ground coffee funnel
- A5. Grinding adjustment dial
- A6. Main switch
- A7. Infuser door
- A8. Infuser
- A9. Power cord
- A10. Condensate tray
- A11. Coffee grounds container
- A12. Cup tray
- A13. Drip tray water level indicator
- A14. Drip tray grille
- A15. Drip tray
- A16. Water tank lid
- A17. Water tank
- A18. Water softener filter housing
- A19. Coffee spouts (adjustable height)
- A20. Cappuccino maker
- A21. Cappuccino maker selection ring
- A22. Hot water and steam connection nozzle
- A23.  button: turns the appliance on and off (standby)
- A24. Cup shelf



### Description of the touch screen

(page 2 - B)

*A number of icons on the touch screen have a double function. This is indicated in brackets in the description.*

- B1. Display: guides the user in using the appliance. The current selection is at the centre between two dotted lines.
- B2.  Selection arrow ("*ESC*": when programming beverages, press to exit without saving the change)
- B3. **OK**: to confirm the selection (*During the first few seconds of "espresso", "ristretto" or "espresso lungo" delivery, press for 2 cups*)
- B4.  Selection arrow ("*STOP*" - When delivering/programming beverages, press to interrupt/programme)
- B5.  *ESC*: appliance settings menu (*When in the settings menu, it acts as the "ESC" to exit from the selected function and go back to the main menu*)
- B6. : hot water
- B7. : aroma selection

### Directly selected beverages:

- B8. : Espresso
- B9. : Coffee
- B10. : Long

B11. : Doppio+

- B12.  DRINK MENU: Beverage selection menu (other than directly selected beverages): Espresso Lungo, Ristretto, Steam, 2 Espresso, 2 Espresso Lungo, 2 Ristretto.
- B13.  MY MENU: My beverages selection menu. Unless previously programmed from the settings menu ("*8.5 Program My beverages*"), the beverage is programmed directly the first time you use the appliance.

### 4.2 Description of the accessories

(page 2 - C)

- C1. Indicator paper
- C2. Pre-ground coffee measure
- C3. Descaler
- C4. Water softener filter (certain models only)
- C5. Cleaning brush

## 5. BEFORE USE

### 5.1 Checking the appliance

After removing the packaging, make sure the product is complete and undamaged and that all accessories (C) are present. Do not use the appliance if it is visibly damaged. Contact De'Longhi Customer Services.

### 5.2 Installing the appliance



#### **Important!**

When you install the appliance, you should respect the following safety warnings:

- The appliance gives off heat. After positioning the appliance on the worktop, leave a space of at least 3 cm between the surfaces of the appliance and the side and rear walls and at least 15 cm above the coffee maker.
- Water penetrating the coffee machine could cause damage.  
Do not place the appliance near taps or sinks.
- The appliance could be damaged if the water it contains freezes.  
Do not install the appliance in a room where the temperature could drop below freezing point.
- Arrange the cord (A9) in such a way that it cannot be damaged by sharp edges or contact with hot surfaces (e.g. electric hot plates).

### 5.3 Connecting the appliance



#### **Important!**

Check that the mains power supply voltage corresponds to that indicated on the rating plate on the bottom of the appliance. Connect the appliance to an efficiently earthed and correctly installed socket with a minimum current rating of 10A only.

If the power socket does not match the plug on the appliance, have the socket replaced with a suitable type by a qualified professional.

## 5.4 Setting up the appliance

### **Please note:**

- Coffee has been used to factory test the appliance and it is therefore completely normal for there to be traces of coffee in the mill. The machine is, however, guaranteed to be new.

You should customise water hardness as soon as possible following the instructions in section "15. Setting water hardness".

1. Connect the appliance to the mains electricity supply (fig. 1) and make sure the main switch (A6) at the back of the appliance is pressed down (fig. 1);
2. "Language": press the selection arrow (B2) until the required language is displayed between the two dotted lines, then press **OK** (B3) to confirm.

Then follow the instructions indicated on the appliance display (B1):

3. "Fill tank": remove the water tank (A17 - fig. 2), fill to the MAX line with fresh water (fig. 3A), then replace in the appliance (fig. 3B);
4. Place a container with a minimum capacity of 100 ml (fig. 4) under the cappuccino maker (A20);
5. "Water circuit empty, Fill water circuit, Hot water, Confirm?";
6. Press **OK** to confirm. The appliance delivers water from the cappuccino maker then goes off automatically.

The coffee machine is now ready for normal use.

### **Please note:**

- The first time you use the appliance, you need to make 4-5 cups of coffee before it starts to give satisfactory results.
- To enjoy your coffee even more and improve the performance of your appliance, we recommend installing a water softener filter (C4) as described in section "16. Water softener filter". If your model is not provided with a filter, you can request one from De'Longhi Customer Services.

## 6. TURNING THE APPLIANCE ON

### **Please note:**

Before turning the appliance on, make sure the main switch (A6) on the back of the appliance is pressed (fig. 1).

Each time the appliance is turned on, it performs an automatic preheat and rinse cycle which cannot be interrupted. The appliance is ready for use only after completion of this cycle.

### **Danger of burns!**

During rinsing, a little hot water comes out of the coffee spouts (A19) and is collected in the drip tray (A15) underneath. Avoid contact with splashes of water.

- To turn the appliance on, press the  button (A23) (fig. 5). The message "Heating Please wait" appears on the display (B1).

After heating, the message "Rinsing" is displayed, together with a progress bar which gradually fills as preparation proceeds. As well as heating the boiler, the appliance also heats the internal circuits by circulating hot water.

The appliance is at temperature when the message "Select your beverage" is displayed.

## 7. TURNING THE APPLIANCE OFF

Whenever the coffee machine is turned off after being used to make coffee, it performs an automatic rinse cycle.

### **Danger of burns!**

During rinsing, a little hot water flows from the coffee spouts (A19). Avoid contact with splashes of water.

- To turn the appliance off, press the  button (A23 - fig. 5);
- The message "Turning off underway Please wait" appears on the display (B1), then (if provided for) the appliance performs a rinse cycle and goes off (standby).

### **Please note!**

If you will not be using the appliance for some time, unplug from the mains socket:

- first turn the appliance off by pressing the  button (fig. 5);
- release the main switch (A6) (fig. 1).

### **Important!**

Never press the main switch while the appliance is on.

## 8. MENU SETTINGS

The menu has 6 items, some divided into subgroups:

- **Rinsing;**
- **Language;**
- **Maintenance:**
  - Descale,
  - Install filter,
  - (if a filter has been installed): Replace filter,
  - (if a filter has been installed): Remove filter;
- **Prg. beverages;**
- **Prg. My beverages;**
- **General:**
  - Set temperature,
  - Water hardness,
  - Auto-off,

- Energy saving,
- Beep,
- Default beverages,
- Default values;
- **Statistics.**

## 8.1 Rinsing

Use this function to deliver hot water from the coffee spouts (A19) to clean and heat the appliance's internal circuit.

Place a container with a minimum capacity of 100ml under the coffee spouts.



### **Important! Danger of burns.**

Do not leave the appliance unattended while hot water is being delivered.

To perform a rinse, proceed as follows:

1. Press  (B5) to enter the "Settings" menu;
2. Press **OK** (B3) to confirm "Rinsing";
3. After a few seconds, hot water is delivered from the coffee spouts to clean and heat the appliance's internal circuit. A progress bar is displayed and fills gradually as preparation proceeds;
4. To interrupt, press the arrow corresponding to "STOP" (B4).





### **Please note!**

- If the appliance is not used for more than 3-4 days, when switched on again, we strongly recommend performing 2/3 rinses before use;
- After cleaning, it is normal for the coffee grounds container (A11) to contain water.

## 8.2 Language

To modify the language of the display (B1), proceed as follows:

1. Press  (B5) to enter the "Settings" menu;
2. Press the selection arrows (B2 and B4) until "Language" is displayed between the two dotted lines;
3. Press **OK** (B3). The available languages are displayed;
4. Press the selection arrows until the required language is displayed between the two dotted lines;
5. Press **OK** to confirm;
6. The appliance goes back to the "Settings" menu;
7. Press /ESC to exit the menu.

## 8.3 Maintenance

Here you can find all the maintenance operations required by the appliance over time:



- **Descaler:** For instructions on descaling, see section "14. Descaling";
- **Install filter:** For instructions on how to install the filter (C4), see section "16.1 Installing the filter".

To select the operation you require, proceed as follows:

1. Press  (B5) to enter the "Settings" menu;
2. Press the selection arrows (B2 and B4) until "Maintenance" is displayed between the two dotted lines;
3. Press **OK** (B3) to confirm;
4. Press the selection arrows to display the operation to be performed;
5. Press **OK** to confirm and perform the operations as described in the corresponding sections.

## 8.4 Program beverages

The appliance is set by default to automatically deliver standard quantities. To change these quantities and customise the directly selected beverages and  DRINK MENU (B12), proceed as follows:

1. Press  (B5) to enter the "Settings" menu;
2. Press the selection arrows (B2 and B4) until "Prg. beverages" is displayed between the two dotted lines;
3. Press **OK** (B3) to confirm: the appliance lists the beverages you can customise;
4. Press the selection arrows until the beverage you want to customise is displayed, then press **OK** to confirm;
5. **Beverages with coffee:** "Program aroma" appears on the display: press the selection arrows (B2 and B4) or  (B7) until the required aroma is selected (see section "9.4 Temporarily varying the coffee aroma"), then press **OK**. "Program coffee" appears on the display together with a bar which gradually fills as delivery progresses. When the required quantity is reached, press **OK**; **Hot water:** press **OK**. Delivery begins: press **OK** when the required quantity is reached.
6. "Save parameters?": to save the settings, press **OK** (otherwise press /ESC - B2 or B5).
7. "Parameters saved" (or "Parameters not saved"). The appliance is ready for use again.

## 8.5 Program My beverages

Follow the procedures described in the previous section "8.4 Program beverages" to customise the beverages in the " MENU" (B13) or proceed with direct programming, as described in section "11. Programming and selecting".

## 8.6 General

Here you can find the settings to customise the basic functions of the appliance:

1. Press  (B5) to enter the "Settings" menu;
2. Press the selection arrows (B2 and B4) until "General" is displayed between the two dotted lines;

3. Press **OK** (B3) to confirm and select the required item with the selection arrows. Then follow the instructions for each setting.

- **Set temperature:**

To modify the temperature of the water used to make the coffee, proceed as follows:

4. Press **OK** (B3). The current value appears on the display (B1) and the "New" value flashes;
5. Select the new value you want to set using the selection arrows (B2 or B4);
6. When the required value (low, medium, high, maximum) has been selected, press **OK**.

The display goes back to the previous screen.

- **Water hardness:**

For instructions on identifying and setting water hardness, see section "15. Setting water hardness".

- **Auto-off (standby):**

Auto-off can be set so that the appliance goes off after 15 or 30 minutes, or 1, 2 or 3 hours

4. Press **OK**. The current value appears on the display (B1) and the "New" value flashes;
5. Select the new value you want to set using the selection arrows (B2 or B4);
6. When the required time has been selected, press **OK**.

The display goes back to the previous screen.

- **Energy saving:**

Use this function to enable or disable energy saving. When enabled, the function reduces energy consumption in compliance with European regulations.

To disable or enable "Energy Saving", proceed as follows:

4. Press **OK**. The current state ("Enabled" or "Disabled") and the operation to be performed ("Disable?" or "Enable?") is displayed. Press **OK** to confirm;
5. Press **OK** to disable or enable the function.

The display goes back to the previous screen.



**Please note!**

- when the function is enabled, the "ECO" symbol appears on the display.
- When in energy saving mode, a few seconds elapse before the first coffee, cappuccino or milk-based coffee is delivered as the appliance must heat up again.

- **Beep:**

Use this function to enable or disable the beep. Proceed as follows:

4. Press **OK**. The current state ("Enabled" or "Disabled") and the operation to be performed ("Disable?" or "Enable?") is displayed. Press **OK** to confirm;
5. Press **OK** to disable or enable the function.

The display goes back to the previous screen.

- **Default beverages:**

Use this function to reset the default values for all the beverages, or the individual beverages programmed previously. Select the beverage, then proceed as follows:

4. Select "All" to reset the aroma and quantity settings to the default values, or select the required beverage, then press **OK**;
5. "Reset?": to reset the default values, press **OK**.
6. "Reset complete": the appliance confirms the reset and goes back to the previous screen.

To reset another beverage, repeat from point 4 or to exit, press /ESC (B5).

- **Default values:**



Use this function to reset all the appliance and beverage settings (apart from the language which remains as selected the first time the appliance was used). Select the item, then proceed as follows:

4. "Reset?"; press **OK**;
5. "Reset complete": the appliance confirms the reset and goes back to the previous screen.

To exit, press /ESC (B5).

## 8.7 Statistics

This displays statistics relating to the machine. To display the statistics, proceed as follows:

1. Press  (B5) to enter the "Settings" menu;
2. Press the selection arrows (B2 and B4) until "Statistics" is displayed between the two dotted lines;
3. Press **OK** (B3): statistics on the appliance are displayed, use the selection arrows to scroll through the items;
4. Then press /ESC (B5) to exit.

To go back to the main screen, press /ESC.

## 9. MAKING COFFEE

### 9.1 Adjusting the coffee mill

The coffee mill is set by default to prepare coffee correctly and should not require regulating initially.

However, if after making the first few coffees you find that the coffee is either too weak and not creamy enough or delivery is too slow (a drop at a time), this can be corrected by calibrating the coffee grinding using the adjustment dial (A5) (fig. 6).



**Please note:**

The grinding adjustment dial must only be turned when the coffee mill is in operation.



If the coffee is delivered too slowly or not at all, turn one click clockwise towards 7. For fuller bodied creamier coffee, turn one click anticlockwise towards 1 (do not turn more than one click at a time otherwise the coffee could be delivered a drop

at a time).

These adjustments will only be evident after at least 2 cups of coffee have been delivered. If this adjustment does not obtain the desired result, turn the dial another click.

## 9.2 Tips for a hotter coffee

For hotter coffee, you should:

- perform a rinse cycle by pressing /ESC (B15);
- warm the cups with hot water using the hot water function (see section "12. Delivering hot water");
- increase the coffee temperature in the "Settings" menu (see section "8.6 General").

## 9.3 Making automatic recipes using coffee beans



### Important!

Do not use green, caramelised or candied coffee beans as they could stick to the coffee mill and make it unusable.

1. Fill the container (A3) (fig. 7) with coffee beans;
2. Place under the coffee spouts (A19):
  - 1 cup, if you want to make 1 coffee (fig. 8);
  - 2 cups if you want 2 coffees.
3. Lower the spouts as near as possible to the cup. This makes a creamier coffee (fig. 9);
4. Then select your required coffee:

Directly selected beverages			
Recipe	Quantity	Program-mable quantity	Default aroma
Espresso (B8)	≈ 40 ml	from ≈30 to ≈ 80ml	
Coffee (B9)	≈ 180 ml	from ≈100 a ≈240ml	
Long (B10)	≈ 160 ml	from ≈115 to ≈250ml	
Doppio+ (B11)	≈ 120 ml	from ≈80 to ≈180ml	

Beverages with coffee selectable from the  DRINK MENU (B12)			
Espresso Lungo	≈ 120 ml	from ≈80 to ≈180ml	
Ristretto	≈ 30 ml	from ≈20 to ≈40ml	
2 Espresso	≈ 40 ml x 2 cups	--	
2 Espresso Lungo	≈ 120 ml x 2 cups	--	
2 Ristretto	≈ 30 ml x 2 cups	--	

5. Preparation begins. A progress bar appears on the display (B1) and gradually fills as preparation proceeds.

### Please note:

- You can prepare 2 cups of RISTRETTO, ESPRESSO or ESPRESSO LUNGO coffee at the same time by pressing "2X" (B3) during preparation of single beverages (the image is displayed for a few seconds at the start of preparation).
- While the machine is making coffee, delivery can be interrupted at any time by pressing the selection arrow corresponding to "STOP" (B4).
- At the end of delivery, to increase the quantity of coffee in the cup, just press and hold (within 3 seconds) one of the coffee icons (B8 to B11).

Once the coffee has been made, the appliance is ready to make the next beverage.

### Please note:

- Various alarm messages could be displayed while using the appliance (fill tank, empty grounds container, etc.). Their meaning is explained in section "19. Displayed messages".
- For hotter coffee, see section "9.2 Tips for a hotter coffee".
- If the coffee is delivered a drop at a time, too weak and not creamy enough or too cold, read the tips in section "20. Troubleshooting".
- To customise the beverages according to personal taste, see sections "8.4 Program beverages" and "8.5 Program My beverages".

## 9.4 Temporarily varying the coffee aroma

To temporarily vary the aroma of the coffee in the automatic recipes, press (B7):

AUTO	Custom (if programmed) / Standard
------	-----------------------------------

	EXTRA LIGHT
	LIGHT
	MEDIUM
	STRONG
	X-STRONG
	(see "9.5 Making coffee using pre-ground coffee")

**i Please note:**

- The variation in aroma is not saved and the next time a beverage is delivered automatically, the appliance selects the default value ( AUTO).
- If a few seconds elapse between temporary customising of the aroma and delivery of the beverage, the aroma returns to the default value ( AUTO).

### 9.5 Making coffee using pre-ground coffee

**! Important!**

- Never add pre-ground coffee when the machine is off or it could spread through the inside of the machine and dirty it. This could damage the appliance.
- Never use more than 1 level measure (C2) or it could dirty the inside of the coffee machine or block the funnel (A4).

**i Please note:**

If you use pre-ground coffee, you can only make one cup of coffee at a time.

1. Press the icon (B7) repeatedly until "" appears on the display (B1).
2. Make sure the funnel is not blocked, then add one level measure of pre-ground coffee (fig. 10).
3. Place a cup under the coffee spouts (A19) (fig. 8).
4. Then select your required coffee:

Directly selected beverages	
Recipe	Quantity
Espresso (B8)	≈ 40 ml
Coffee (B9)	≈ 180 ml
Long (B10)	≈ 160 ml

**Beverages with coffee selectable from the DRINK MENU (B12)**

Espresso Lungo	≈ 120 ml
Ristretto	≈ 30 ml

5. Preparation begins. The beverage selected appears on the display together with a progress bar which gradually fills as preparation proceeds.

**! Important! Making LONG coffee :**

Halfway through preparation, the message "Add pre-ground coffee" appears on the display (B1). Add one level measure of pre-ground coffee and press **OK** (B3).

**i Please note:**

If "Energy Saving" mode is active, you may have to wait a few seconds before the first coffee is delivered.

## 10. MAKING CAPPUCCINO AND HOT MILK (NOT FROTHED)

**! Danger of burns!**

During preparation steam is given off. Take care to avoid scalds.

1. When preparing cappuccino, make the coffee in a large cup;
2. Fill a container (preferably one with a handle to avoid scalding) with about 100 grams of milk for each cappuccino. In choosing the size of the container, bear in mind that the milk doubles or triples in volume;

**i Please note:**

For a richer denser froth, use skimmed or partially skimmed milk at refrigerator temperature (about 5°C). To avoid milk with poor froth or large bubbles, always clean the cappuccino maker (A20) as described in section "10.2 Cleaning the cappuccino maker after use".

3. Make sure the cappuccino maker selection ring (A21) is positioned downwards in the "CAPPUCCINO" position (fig. 11);
4. The cappuccino maker can be turned slightly outwards to allow containers of any size to be used.

**! Important!**

Never use force to turn the cappuccino maker (fig. 12). It could break!

5. Immerse the cappuccino maker in the milk container. Never immerse the black ring;
6. Press DRINK MENU (B12);
7. Press the selection arrows (B2 and B4) until "Steam" is displayed between the two dotted lines;
8. Press **OK** (B5). "Steam" is displayed. After a few seconds, steam is delivered from the cappuccino maker, giving

the milk a creamy frothy appearance and making it more voluminous;

9. For a creamier froth, rotate the container with slow movements in an upward direction;
10. When the required temperature is obtained, interrupt steam delivery by pressing the selection arrow corresponding to "STOP".



### **Danger of burns!**

Stop steam delivery before removing the container with the frothed milk to avoid burns caused by splashes of boiling milk.

11. Add the milk froth to the coffee prepared previously. The cappuccino is ready. Sweeten to taste and, if desired, sprinkle the froth with a little cocoa powder.



### **Please note!**

If "Energy saving" is active, you may have to wait a few seconds before steam is delivered.

## **10.1 Making hot milk (not frothed)**

To make hot milk without froth, proceed as described in the above section, but with the cappuccino maker selection ring (A21) positioned upwards in the "HOT MILK" position.

## **10.2 Cleaning the cappuccino maker after use**

Clean the cappuccino maker (A20) each time you use it to avoid the build-up of milk residues or blockages.





### **Danger of burns!**

When cleaning the cappuccino maker, a little hot water is delivered. Avoid contact with splashes of water.

1. Deliver a little water by pressing the  icon (B6 - fig. 13). To interrupt, press the selection arrow (B4) corresponding to "STOP".
2. Wait a few minutes for the cappuccino maker to cool down. Turn the cappuccino maker downwards to remove it (fig. 14).
3. Move the selection ring (A21) upwards (fig. 15).
4. Remove the connection nozzle downwards (A22 - fig. 16).
5. Make sure the two holes shown by the arrow in fig. 17 are not blocked. If necessary, clean with a pin.
6. Replace the connection nozzle, move the selection ring downwards and put the cappuccino maker back on the nozzle (fig. 18), turning it clockwise and pushing it upwards until it is attached.

## **11. "my MENU" PROGRAMMING AND SELECTING**

In  you can select beverages customised to your personal tastes. If the beverages have not yet been programmed, the appliance will request the customisation procedure before proceeding with delivery:

1. Press  (B13);
2. Press the selection arrows (B2 and B4) until the required beverage is displayed between the two dotted lines;

### **Unprogrammed beverages:**

3. Press **OK** (B3) to select;
4. "Program aroma" appears on the display. Press the selection arrows (B2 and B4) or  (B7) until the required aroma is selected. Press **OK**. "Program coffee" appears on the display together with a bar which gradually fills as delivery progresses. When the required quantity is reached, press **OK**.
5. The appliance then makes the coffee. Press **OK** to interrupt delivery when the required quantity of coffee is reached.
6. "Save parameters?": to save the settings, press **OK** (otherwise press **ESC** - B2 or B5).
8. "Parameters saved" (or "Parameters not saved"). The appliance is ready for use again.

### **Programmed beverages:**

3. Press **OK** (B3) to select;
4. Preparation begins according to the previously programmed settings.



### **Please note:**

Two cups of a beverage can only be selected when the corresponding single beverages have been programmed.

## **12. DELIVERING HOT WATER**



### **Important! Danger of burns.**

Never leave the machine unattended while delivering hot water. The cappuccino maker (A20) becomes hot while water is being delivered and must be held by the black ring (A21) only.

1. Place a container under the cappuccino maker (A20) (as close as possible to avoid splashes).
2. Press  (B6 - fig. 13). "HOT WATER" appears on the display (B1), together with a progress bar which fills gradually as preparation proceeds.
4. The machine delivers about 250 ml of hot water, then delivery stops automatically. To interrupt hot water delivery manually, press the selection arrow (B4) corresponding to "STOP" again.



### **Please note!**

If "Energy Saving" is active, you may have to wait a few seconds before hot water and steam are delivered.



## 13. CLEANING

### 13.1 Cleaning the machine

The following parts of the machine must be cleaned regularly:

- the appliance's internal circuit;
- coffee grounds container (A11);
- drip tray (A15) and condensate tray (A10);
- water tank (A17);
- coffee spouts (A19);
- pre-ground coffee funnel (A4);
- infuser (A8), accessible after opening the infuser door (A7);
- cappuccino maker (A20 - section "10.2 Cleaning the cappuccino maker after use");
- touch screen (B).



#### **Important!**

- Do not use solvents, abrasive detergents or alcohol to clean the coffee machine. With De'Longhi superautomatic coffee machines, you need not use chemical products to clean the machine.
- None of the components of the appliance can be washed in a dishwasher with the exception of the drip tray grille (A14).
- Do not use metal objects to remove encrustations or coffee deposits as they could scratch metal or plastic surfaces.

### 13.2 Cleaning the machine's internal circuit

If the appliance is not used for more than 3/4 days, before using it again, we strongly recommend switching it on and:

- performing 2/3 rinse cycles (see section "8.1 Rinsing");
- delivering hot water for a few seconds (section "12. Delivering hot water").



#### **Please note:**

After cleaning, it is normal for the coffee grounds container (A11) to contain water.

### 13.3 Cleaning the coffee grounds container

When "Empty grounds container" appears on the display (B1), the grounds container must be emptied and cleaned. The appliance cannot be used to make coffee until you have cleaned the grounds container (A11). Even if not full, the empty grounds container message appears on the display 72 hours after the first coffee has been prepared. For the 72 hours to be calculated correctly, the machine must never be turned off with the main switch (A6).



#### **Important! Danger of burns**

If you make a number of cappuccinos one after the other, the metal cup tray (A12) becomes hot. Wait for it to cool down before touching it and handle it from the front only.

To clean (with the machine on):

- Remove the drip tray (A15) (fig. 19), empty and clean.
- Empty the grounds container (A11) and clean thoroughly to remove all residues left on the bottom.
- Check the condensate tray (A10) (red) and empty if necessary.

### 13.4 Cleaning the drip tray and condensate tray



#### **Important!**

The drip tray (A15) is fitted with a level indicator (A13) (red) showing the level of water it contains (fig. 20). Before the indicator protrudes from the cup tray (A12), the drip tray must be emptied and cleaned otherwise the water may overflow the edge and damage the appliance, the surface it rests on or the surrounding area.

To remove the drip tray:

1. Remove the drip tray and coffee grounds container (A11) (fig. 19);
2. Remove the cup tray (A12) and drip tray grille (A14), then empty the drip tray and grounds container and wash all components;
3. Check the red condensate tray (A10) and empty if necessary;
4. Replace the drip tray complete with grille and grounds container.



#### **Important!**

When removing the drip tray, the grounds container must be emptied, even if it contains few grounds.

If this is not done, when you make the next coffees, the grounds container may fill up more than expected and clog the machine.

### 13.5 Cleaning the inside of the coffee machine



#### **Danger of electric shock!**

Before cleaning internal parts, the machine must be turned off (see section "7. Turning the appliance off") and unplugged from the mains power supply. Never immerse the coffee machine in water.

1. Check regularly (about once a month) that the inside of the appliance (accessible after removing the drip tray (A15) is not dirty. If necessary, remove coffee deposits with the brush supplied and a sponge;
2. Remove all the residues with a vacuum cleaner (fig. 21).

### 13.6 Cleaning the water tank

1. Clean the water tank (A17) regularly (about once a month) and whenever you replace the water softener filter (C4) (if provided) with a damp cloth and a little mild washing up liquid;

2. Remove the filter (C4) (if present) and rinse with running water;
3. Replace the filter (if provided), fill the tank with fresh water and replace the tank;
4. (Models with water softener filter only) Deliver about 100ml of water.

### 13.7 Cleaning the coffee spouts

1. Clean the coffee spouts (A19) regularly with a sponge or cloth (fig. 22A);
2. Check that the holes in the coffee spouts are not blocked. If necessary, remove coffee deposits with a toothpick (fig. 22B).

### 13.8 Cleaning the pre-ground coffee funnel

Check regularly (about once a month) that the pre-ground coffee funnel (A4) is not blocked. If necessary, remove coffee deposits with a brush.

### 13.9 Cleaning the infuser

The infuser (A8) must be cleaned at least once a month.



#### **Important!**

The infuser may not be extracted when the machine is on.

1. Make sure the machine is correctly turned off (see section "7. Turning the appliance off");
2. Remove the water tank (A17);
3. Open the infuser door (A7) (fig. 23) on the right side of the appliance;
4. Press the two coloured release buttons inwards and at the same time pull the infuser outwards (fig. 24);
5. Soak the infuser in water for about 5 minutes, then rinse under the tap;



#### **Important!**

RINSE WITH WATER ONLY

NO WASHING UP LIQUID - NO DISH WASHER

Clean the infuser without using washing up liquid as it could be damaged.

6. Use the brush to remove any coffee residues left in the infuser housing, visible through the infuser door;
7. After cleaning, replace the infuser by sliding it onto the internal support, then push the PUSH symbol fully in until it clicks into place;



#### **Please note:**

If the infuser is difficult to insert, before insertion, adapt it to the right size by pressing the two levers (fig. 25).

8. Once inserted, make sure the two coloured buttons have snapped out;

9. Close the infuser door;
10. Put the water tank back.

## 14. DESCALING



### **Important!**

- Before use, read the instructions and the labelling on the descaler pack.
- You should use De'Longhi descaler only. Using unsuitable descaler and/or performing descaling incorrectly may result in faults not covered by the manufacturer's guarantee.

Descale the machine when "Descale, ESC to cancel, OK to descale (~45 minutes)" appears on the display (B1). To descale immediately, press **OK** (B3) and follow the instructions from point 6. To descale the appliance later, press **ESC** (B5). The  symbol on the display reminds you that the appliance needs descaling. To access the descaling menu:

1. Turn the appliance on and wait until it is ready for use;
2. Press  (B5) to enter the "Settings" menu;
3. Press the selection arrows (B2 and B4) until "Maintenance" is displayed between the two dotted lines. Press **OK** (B3);
4. Press **OK** to select "Descale";
5. Confirm? (~45 minutes)": Press **OK** to confirm;
6. "Remove filter": extract the water tank (A17), remove the water softener filter (C4) (if present) and empty the water tank. Press **OK**;
7. "Pour descaler and water into tank": Pour the descaler into the tank up to level A (corresponding to a 100ml pack) marked on the inner surface of the tank, then add water (one litre) up to level **B** (fig. 26) and put the water tank back. Press **OK**;
8. "Empty drip tray": Remove, empty and replace the drip tray (A15) and grounds container (A11). Press **OK**;



#### **Please note:**

In certain cases, a cooling process lasting several seconds may take place before moving on to the next point.

9. "Place 1.8L container empty under spouts": Place an empty container with a minimum capacity of 1.8 litres under the cappuccino maker (A20) and coffee spouts (A19) (fig. 27). Press **OK**;



#### **Important! Danger of burns**

Hot water containing acid flows out of the coffee spouts and hot water spout. Take care to avoid contact with splashes of this solution.

10. "Descaling underway": The descale programme starts and the descaler liquid comes out of the cappuccino maker and

coffee spouts. A series of rinses and pauses is performed automatically to remove all the scale residues inside the coffee machine;

After about 35 minutes, descaling stops;

11. "Rinse tank and fill with water": the appliance is now ready to rinse with fresh water. Empty the container used to collect the descaler solution. Extract the water tank, empty, rinse under running water, fill with fresh water up to the MAX level and put back in the appliance. Press **OK**;
12. "Place 1.8L container empty under spouts": place the container used to collect the descaler solution empty under the coffee spouts and hot water spout (fig. 27) and press **OK**;
13. "Rinsing Confirm?": press **OK**;
14. "Rinsing underway": hot water is delivered first from the coffee spouts, then from the cappuccino maker;
15. When the water in the tank has run out, empty the container used to collect the rinsing water;
16. "Rinse tank and fill with water": extract the water tank and fill with fresh water up to the MAX level. Press **OK**;
14. "Insert filter": put the water softener filter (if removed) back in its housing in the water tank, and replace the tank in the appliance. Press **OK**;
15. "Place 1.8L container empty under spouts": Place the container used to collect the descaler solution empty under the cappuccino maker. Press **OK**;
16. "Rinsing Confirm?": press **OK**;
17. "Rinsing underway". Hot water comes out of the cappuccino maker;
18. "Empty drip tray": At the end of the second rinse, remove, empty and replace the drip tray (A15) and grounds container (A11). Press **OK**;
19. "Descal complete": press **OK**;
20. "Fill tank": empty the container used to collect the rinse water, remove the water tank and fill with fresh water up to the MAX level, then put back in the appliance.

Descaling is complete.

### **i** Please note!

- If the descaling cycle is not completed correctly (e.g. no electricity) we recommend repeating the cycle;
- After descaling, it is normal for the grounds container (A11) to contain water;
- If the water tank has not been filled to the MAX level, at the end of descaling, the appliance requests a third rinse to guarantee that the descaler solution has been completely eliminated from the machine's internal circuits.

## **15. SETTING WATER HARDNESS**

The descale message is displayed after a period of time established according to water hardness.

The machine is set by default for a hardness level of 4. The machine can also be programmed according to the hardness of the mains water in the various regions so that the machine needs to be descaled less often.

### **15.1 Measuring water hardness**

1. Remove the "TOTAL HARDNESS TEST" indicator paper (C1) from its pack (attached to the English instructions);
2. Immerse the paper completely in a glass of water for one second;
3. Remove the paper from the water and shake lightly. After about a minute, 1, 2, 3, or 4 red squares form, depending on the hardness of the water. Each square corresponds to 1 level;

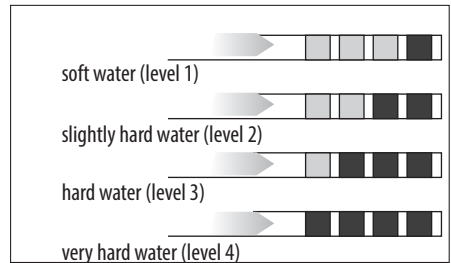

### **15.2 Setting water hardness**

1. Press **⚙️** (B5) to enter the "Settings" menu;
2. Press the selection arrows (B2 and B4) until "General" is displayed between the two dotted lines. Press **OK** (B3);
3. Press the selection arrows until "Water hardness" is displayed, then press **OK**;
4. The current selection appears on the display and the new selection flashes. Press the selection arrows until the required new selection is displayed. Press **OK**.

The new level is saved and the appliance goes back to the "General" menu.

Press **⏪/ESC** (B5) twice to go back to the main screen.

## **16. WATER SOFTENER FILTER**

Certain models are fitted with a water softener filter (C4). If this is not the case with your model, you are recommended to purchase one from De'Longhi Customer Services.

To use the filter correctly, follow the instructions below.

### **16.1 Installing the filter**

1. Remove the filter (C4) from the packaging. The date indicator disk varies according to the filter provided.
2. Turn the date indicator disk (fig. 28) until the next 2 months of use are displayed.

### **Please note**

The filter lasts about two months if the appliance is used normally. If the coffee machine is left unused with the filter installed, it will last a maximum of 3 weeks.



3. To activate the filter, run tap water through the hole in the filter as shown in fig. 29 until water comes out of the openings at the side for more than a minute.;
4. Extract the tank (A17) from the appliance and fill with water;
5. Insert the filter in the water tank and immerse it completely for about ten seconds, sloping it and pressing it lightly to enable the air bubbles to escape (fig. 30).
6. Insert the filter in the filter housing (A18) and press as far as it will go (fig. 31);
7. Close the tank with the lid (A16 - fig. 32), then replace the tank in the machine;

When you install the filter, you must notify the appliance of its presence.

8. Press  (B5) to enter the "Settings" menu;
9. Press the selection arrows (B2 and B4) until "Maintenance" is displayed between the two dotted lines. Press **OK** (B3);
10. Press the selection arrows until "Install filter" is displayed, then press **OK**;
11. Confirm?": press **OK**;
12. "Hot water, Confirm?": Position a container under the cappuccino maker (A20) (min. capacity: 500ml), then press **OK**;
13. The appliance begins hot water delivery and the message "Please wait" is displayed;
14. After the flow of hot water stops, the appliance automatically resets to "Ready for coffee" status.

The filter is now active and you can use the coffee machine.

## 16.2 Replacing the filter

Replace the filter (C4) when "Replace filter, ESC to cancel, OK to replace" appears on the display (B1). To replace immediately, press **OK** (B3) and follow the instructions from point 7. To replace later, press /ESC (B5). The  symbol on the display reminds you that the filter needs replacing.

To replace the filter, proceed as follows:

1. Extract the tank (A17) and exhausted filter;
2. Take the new filter out of its packet and proceed as illustrated in points 2, 3, 4, 5, 6 and 7 in the previous section;
3. Press  (B5) to enter the "Settings" menu;
4. Press the selection arrows (B2 and B4) until "Maintenance" is displayed between the two dotted lines. Press **OK**;
5. Press the selection arrows until "Replace filter" is displayed, then press **OK**;
6. Confirm?": press **OK**;

7. "Hot water, Confirm?": Position a container under the cappuccino maker (A20) (min. capacity: 500ml), then press **OK**;
8. The appliance begins hot water delivery and the message "Please wait" is displayed;
9. After the flow of hot water stops, the appliance automatically resets to "Ready for coffee" status.

The new filter is now active and you can use the coffee machine.

### **Please note!**

After two months (see date indicator) or when the appliance has not been used for 3 weeks, you should replace the filter even if the message has not yet been displayed.

## 16.3 Removing the filter

If you want to use the appliance without the filter (C4), you must remove it and notify the appliance of its removal. Proceed as follows:

1. Extract the tank (A17) and exhausted filter;
2. Press  (B5) to enter the "Settings" menu;
3. Press the selection arrows (B2 and B4) until "Maintenance" is displayed between the two dotted lines. Press **OK** (B3);
4. Press the selection arrows until "Remove filter" is displayed, then press **OK**;
5. "Confirm?": press **OK** to confirm removal. The appliance goes back to the "Maintenance" menu;

Press /ESC (B5) to exit the menu.

### **Please note!**

After two months (see date indicator) or when the appliance has not been used for 3 weeks, you should replace the filter even if the message has not yet been displayed.

## 17. TECHNICAL DATA

Voltage:	220-240 V~ 50/60 Hz max. 10A
Absorbed power:	1450W
Pressure:	1.5MPa (15 bars)
Max. water tank capacity:	1.8 L
Size LxDxH:	240x440x360 mm
Cord length:	1150 mm
Weight:	9.3 kg
Max. beans container capacity:	300 g



 This appliance conforms to EC Regulation 1935/2004 on materials and articles intended to come into contact with food.

## 18. DISPOSING OF THE APPLIANCE

 The appliance must not be disposed of with household waste, but taken to an authorised waste separation and recycling centre.

## 19. DISPLAYED MESSAGES

DISPLAYED MESSAGE	POSSIBLE CAUSE	REMEDY
Fill tank	Insufficient water in the tank (A17).	Fill the tank with water and/or insert it correctly, pushing it as far as it will go until it clicks into place (fig. 3B).
Insert tank	The tank (A17) is not correctly in place.	Insert the tank correctly and press as far as it will go (fig. 3B).
Empty grounds container	The grounds container (A11) is full.	Empty the grounds container and drip tray (A15), clean and replace. Important: when removing the drip tray, the grounds container must be emptied, even if it contains few grounds. If this is not done, when you make the next coffees, the grounds container may fill up more than expected and clog the machine.
Insert grounds container	After cleaning, the grounds container (A11) has not been replaced.	Remove the drip tray (A15) and insert the grounds container.
Add pre-ground coffee	The "pre-ground coffee" function has been selected without placing any pre-ground coffee in the funnel (A4).	Place pre-ground coffee in the funnel (fig. 10) or deselect the "pre-ground" function.
	A LONG coffee with pre-ground coffee has been requested	Put one level measure of pre-ground coffee into the pre-ground coffee funnel (A4) and press OK (B3) to continue and complete preparation.
Fill beans container	The coffee beans have run out.	Fill the beans container (A3) (fig. 7).
	The pre-ground coffee funnel (A4) is clogged.	Empty the funnel with the help of the brush as described in section "13.8 Cleaning the pre-ground coffee funnel".
Ground too fine Adjust mill	The grinding is too fine and the coffee is delivered too slowly or not at all.	Repeat coffee delivery and turn the grinding adjustment dial (A5) (fig. 6) one click clockwise towards 7 while the coffee mill is in operation. If after making at least 2 coffees delivery is still too slow, repeat the correction procedure, turning the grinding adjustment dial another click until delivery is correct (see section "9.1 Adjusting the coffee mill"). If the problem persists, make sure the water tank (A17) is fully inserted.
	If the water softener filter (C4) is present, an air bubble may have been released inside the circuit, obstructing delivery.	Deliver a little water from the cappuccino maker (A20) until it flows out normally.
Less coffee	Too much coffee has been used.	Select a lighter taste by pressing  (B7) or reduce the quantity of pre-ground coffee.
Insert infuser assembly	The infuser (A8) has not been replaced after cleaning.	Insert the infuser as described in section "13.9 Cleaning the infuser".

Water circuit empty Fill water circuit Hot water Confirm?	The water circuit is empty.	Press <b>OK</b> (B3) and deliver water from the cappuccino maker (A20) until it flows out normally. If the problem persists, make sure the water tank (A17) is fully inserted.
Descale ESC to cancel OK to descale (~45 minutes)	The machine must be descaled.	The descaling procedure described in section "14. Descaling" needs to be performed.
Replace filter ESC to cancel OK to replace	The water softener filter (C4) is exhausted.	Replace the filter or remove it as described in section "16. Water softener filter".
General alarm	The inside of the appliance is very dirty.	Clean the inside of the appliance thoroughly, as described in section "13. Cleaning". If the message is still displayed after cleaning, contact Customer Services.
	The water softener filter (C4) is exhausted and must be replaced or removed.	Replace the filter or remove it as described in section "16. Water softener filter".
	The machine must be descaled.	The descaling procedure described in section "14. Descaling" needs to be performed.
<b>ECO</b>	Energy saving is enabled.	To disable energy saving, proceed as described in section "8.6 General" - "Energy saving:"

## 20. TROUBLESHOOTING

Below is a list of some of the possible malfunctions.

If the problem cannot be resolved as described, contact Customer Services.

PROBLEM	POSSIBLE CAUSE	REMEDY
The coffee is not hot.	The cups were not preheated.	Warm the cups by rinsing them with hot water (Please note: you can use the hot water function).
	The internal circuits of the appliance have cooled down because 2/3 minutes have elapsed since the last coffee was made.	Before making coffee, heat the infuser by performing a rinse cycle (see section "8.1 Rinsing").
	A low coffee temperature is set.	Set a higher coffee temperature in the menu.
The coffee is weak or not creamy enough.	The coffee is ground too coarsely.	Turn the grinding adjustment dial (A5) one click anticlockwise towards 1 while the coffee mill is in operation (fig. 7). Continue one click at a time until coffee delivery is satisfactory. The effect is only visible after delivering 2 coffees (see section "9.1 Adjusting the coffee mill").
	The coffee is unsuitable.	Use pre-ground coffee for espresso machines.
The coffee is delivered too slowly or a drop at a time.	The coffee is ground too finely.	Turn the grinding adjustment dial (A5) one click clockwise towards 7 while the coffee mill is in operation (fig. 7). Continue one click at a time until coffee delivery is satisfactory. The effect is only visible after delivering 2 coffees (see section "9.1 Adjusting the coffee mill").
The appliance will not make coffee	The appliance has detected impurities in its internal circuits. "Please wait" is displayed.	Wait for the appliance to be ready for use again and reselect the required beverage. Contact Customer Services if the problem persists.
Coffee does not come out of one or both of the spouts.	The coffee spouts (A19) are blocked.	Clean the spouts with a toothpick (fig. 24B).
The appliance does not come on	It is not plugged into the mains socket.	Plug into the mains socket (fig. 1).
	The main switch (A6) is not turned on.	Place the main switch in the I position (fig. 2).
The infuser cannot be extracted	The appliance has not been turned off correctly	Turn the appliance off by pressing the  button (A23) (fig. 5) (see section "7. Turning the appliance off").
At the end of descaling, the appliance requests a third rinse	During the two rinse cycles, the water tank has not been filled to the MAX level.	Follow the instructions displayed by the appliance, but first empty the drip tray to avoid the water overflowing.

The frothed milk has large bubbles	The milk is not cold enough or is not semi-skimmed	You should ideally use skimmed or semi-skimmed milk at refrigerator temperature (about 5°C). If the result is not as you wished, try changing brand of milk.
The milk is not frothed	The cappuccino maker (A20) is dirty	Clean as described in section "10.2 Cleaning the cappuccino maker after use".
	The ring on the cappuccino maker (A21) is in the "HOT MILK" position.	Push the ring into the "CAPPUCCINO" position (fig. 11).
Steam delivery stops	A safety device stops steam delivery	Wait a few minutes and then enable the steam function again.

## 21. ELECTRICAL REQUIREMENTS

Before using this appliance ensure that the voltage indicated on the product corresponds with the main voltage in your home, if you are in any doubt about your supply contact your local electricity company.

The flexible mains lead is supplied connected to a B.S. 1363 fused plug having a fuse of 13 amp capacity.

Should this plug not fit the socket outlets in your home, it should be cut off and replaced with a suitable plug, following the procedure outlined below.

**Note:** Such a plug cannot be used for any other appliance and should therefore be properly disposed of and not left where children might find it and plug it into a supply socket - with the obvious consequent danger.

**Please note:** We recommend the use of good quality plugs and wall sockets that can be switched off when the machine is not in use.

**IMPORTANT:** The wires in the mains lead fitted to this appliance are coloured in accordance with the following code:

GREEN AND YELLOW  
BLUE  
BROWN

EARTH  
NEUTRAL  
LIVE

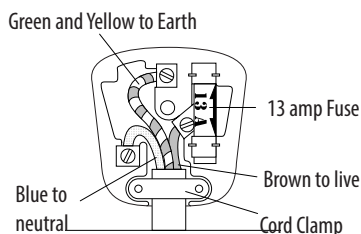

As the colours of the wires in the mains lead of this appliance may not correspond with the coloured markings identifying the terminals in your plug, proceed as follows:

- The wire which is coloured green and yellow must be connected to the terminal in the plug which is marked with the letter E or by the earth symbol  $\perp$  or coloured green or green and yellow.
- The wire which is coloured blue must be connected to the terminal which is marked with the letter N or coloured black.
- The wire which is coloured brown must be connected to the terminal which is marked with the letter L or coloured red.

When wiring the plug, ensure that all strands of wire are securely retained in each terminal. Do not forget to tighten the mains lead clamp on the plug. If your electricity supply point has only two pin socket outlets, or if you are in doubt, consult a qualified electrician.

Should the mains lead ever require replacement, it is essential that this operation be carried out by a qualified electrician and should only be replaced with a flexible cord of the same size.

After replacement of a fuse in the plug, the fuse cover must be refitted. If the fuse cover is lost, the plug must not be used until a replacement cover is obtained. The colour of the correct replacement fuse cover is that of the coloured insert in the base of the fuse recess or elsewhere on the plug. Always state this colour when ordering a replacement fuse cover.

Only 13amp replacement fuses which are asta approved to B.S. 1362 should be fitted.

This appliance conforms to the Norms EN 55014 regarding the suppression of radio interference.

**Warning - this appliance must be earthed**