



## MILK FROTHER

Instructions for use. Keep these instructions  
Visit [www.delonghiregistration.com](http://www.delonghiregistration.com) to register  
your product

Visit [www.delonghi.com](http://www.delonghi.com) for a list of service centers  
near you.

### ELECTRIC CHARACTERISTICS

120 V~ 60 Hz 500 W



## MOUSSEUR À LAIT

Mode d'emploi . Conservez cette notice

Visitez [www.delonghiregistration.com](http://www.delonghiregistration.com) pour  
enregistrer votre produit en ligne.

Visitez [www.delonghi.com](http://www.delonghi.com) pour y voir une liste des  
centres de réparation proches de chez vous.

### CARACTÉRISTIQUES ÉLECTRIQUES

120 V~ 60 Hz 500 W

## BATIDOR DE LECHE

Repase y guarde estas instrucciones.

Lea cuidadosamente este instructivo antes de usar  
su aparato.

Visite [www.delonghiregistration.com](http://www.delonghiregistration.com) para registrar  
su producto en línea.

Visite [www.delonghi.com](http://www.delonghi.com) para ver la lista de  
centros de servicios cercanos a usted.

### CARACTERISTICAS ELECTRICAS:

120 V~ 60 Hz 500 W

**EN**

page 9

**FR**

page 10

**ES**

page 14

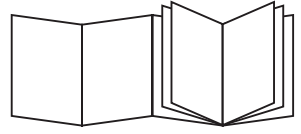

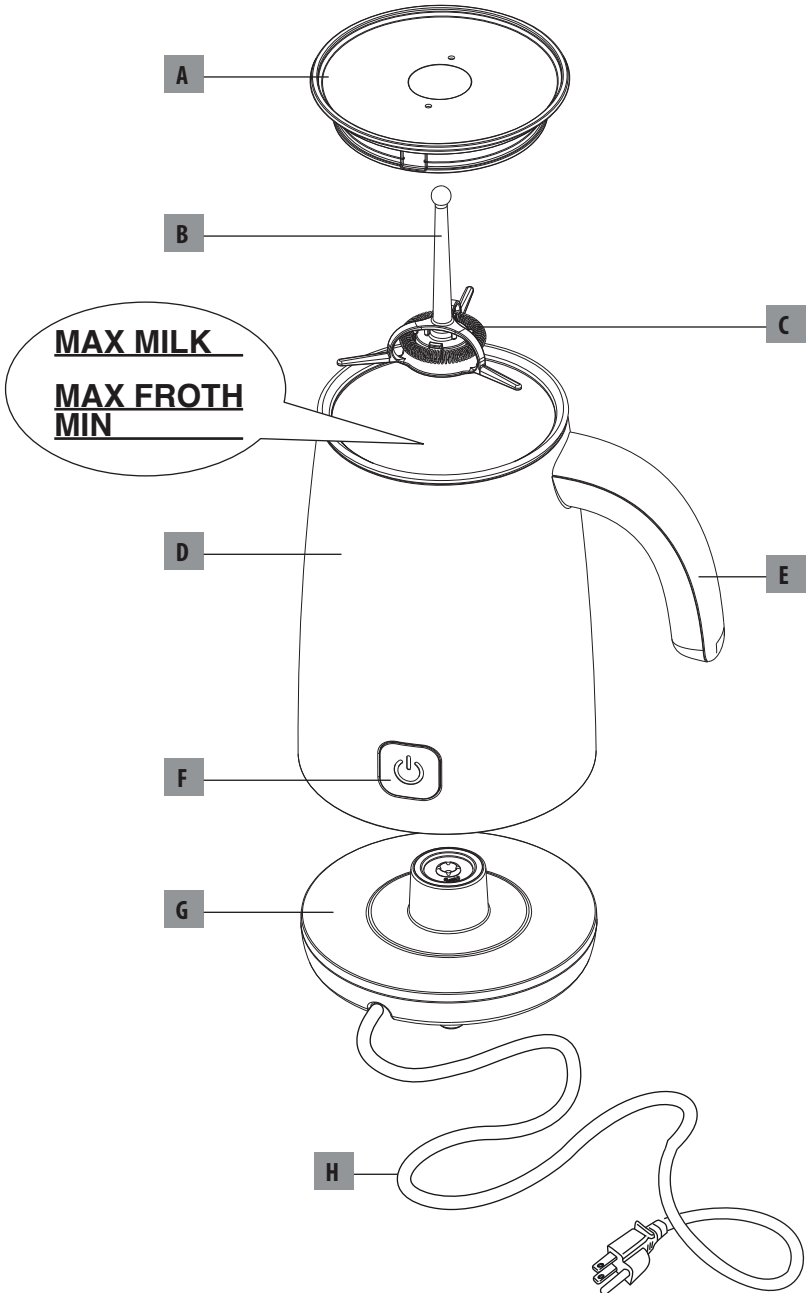

# USE

Utilisation  
Usò

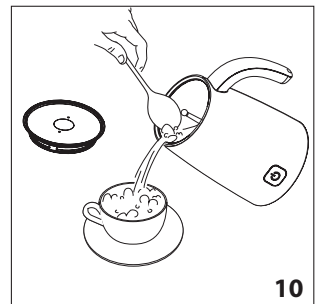
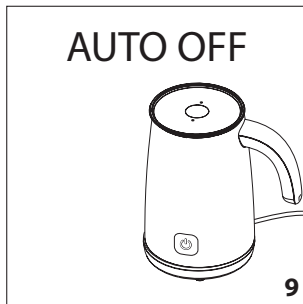
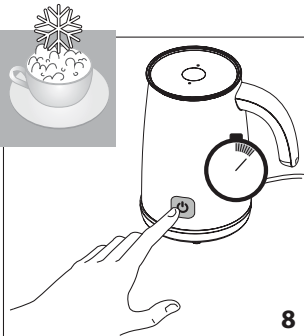
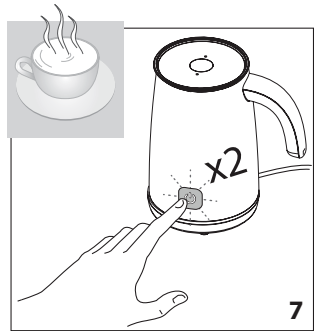
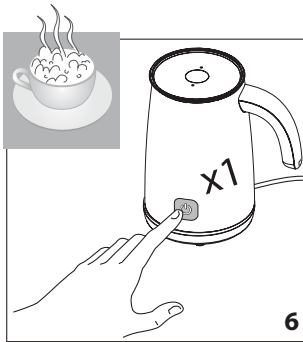
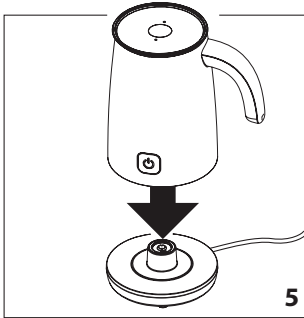
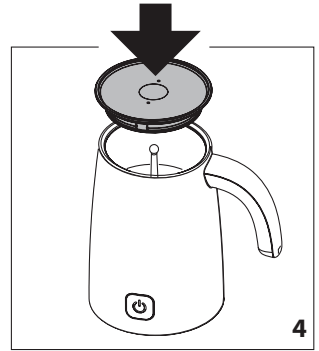
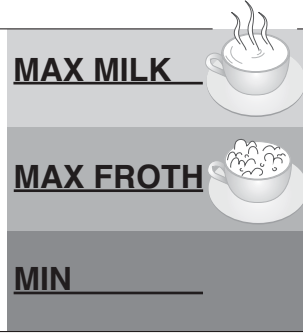
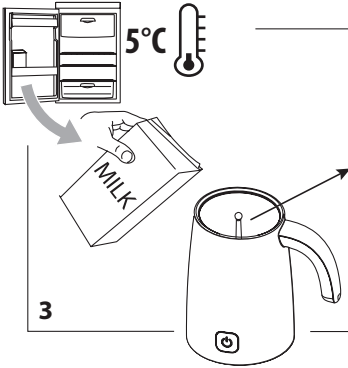
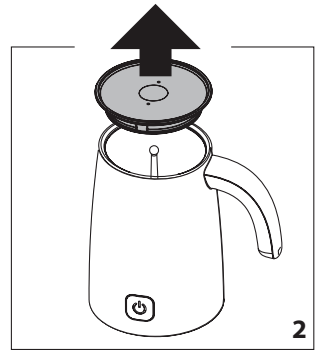
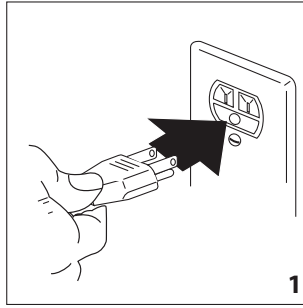

# CLEANING

Nettoyage  
Limpeza

