

ETAM29.62X

BEAN TO CUP ESPRESSO
AND CAPPUCCINO
MACHINE
Instruction for Use

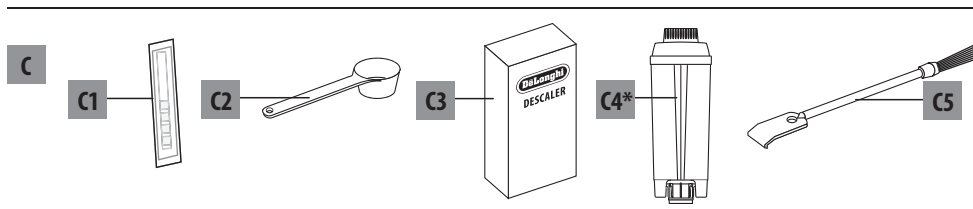

DeLonghi

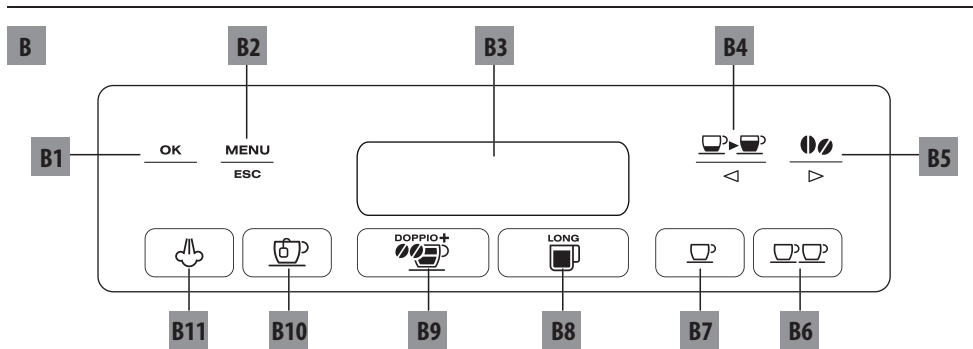
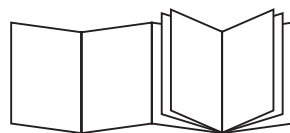

A

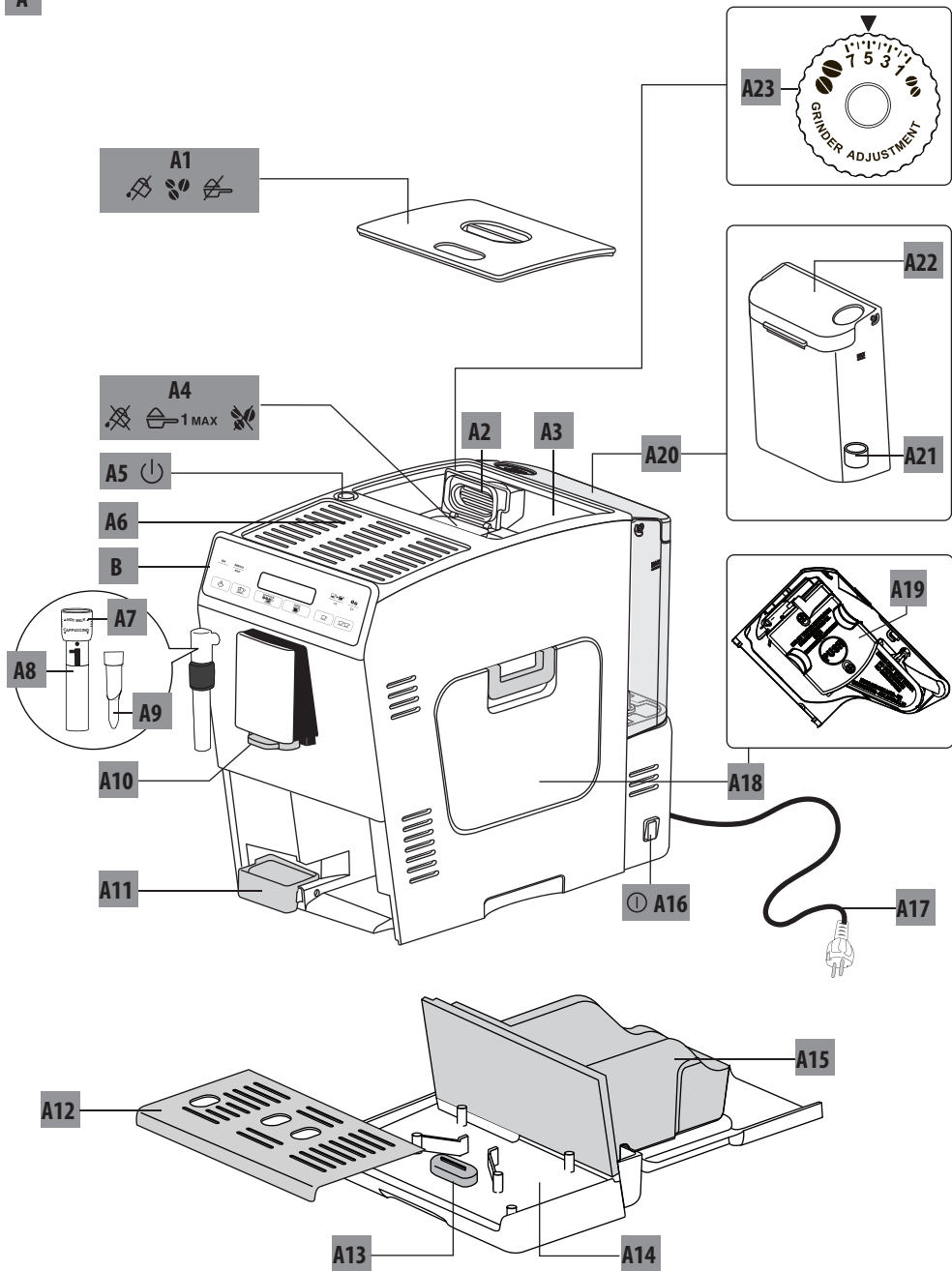

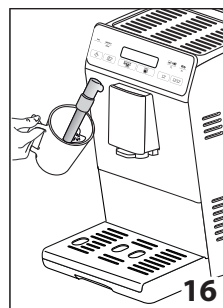
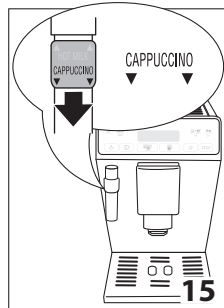
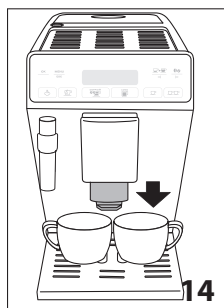
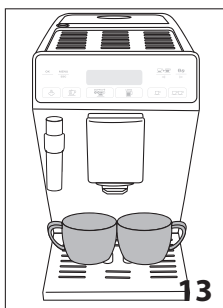
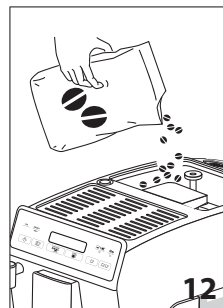
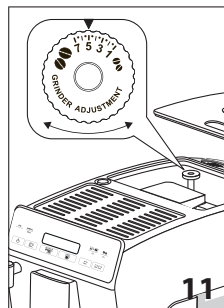
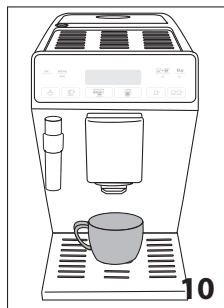
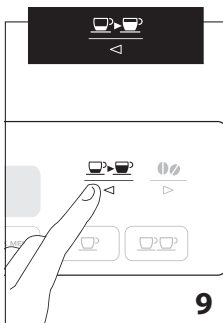
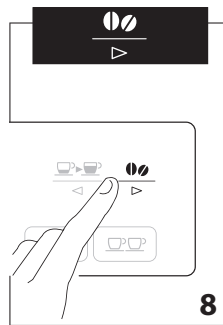
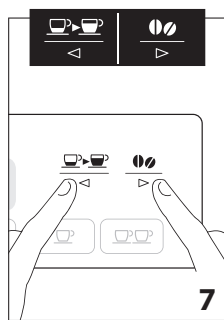
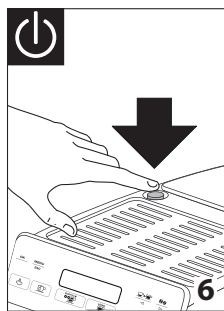
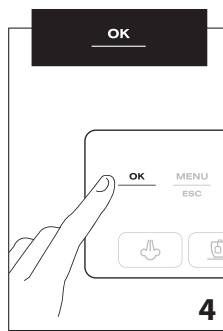
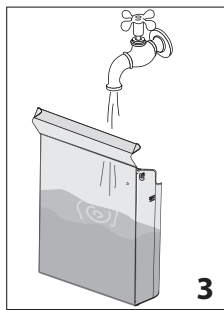
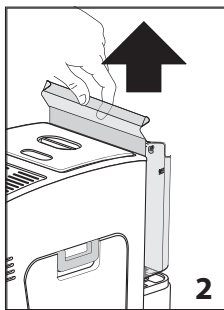
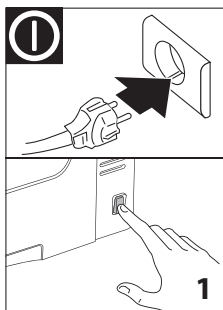

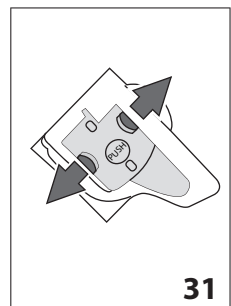
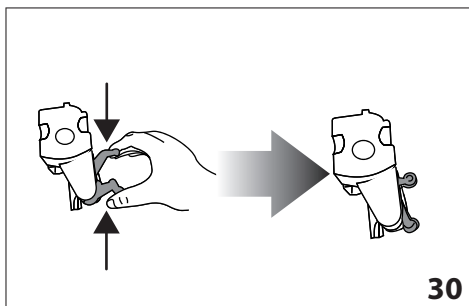
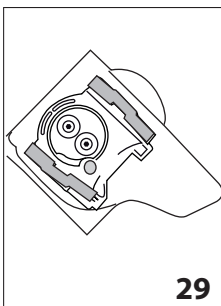
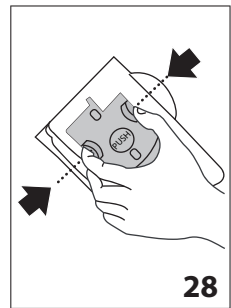
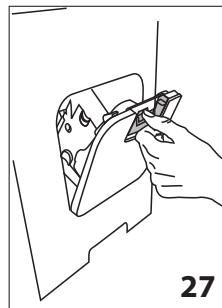
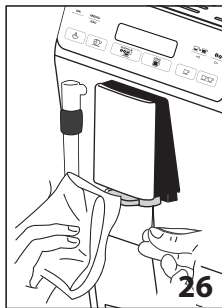
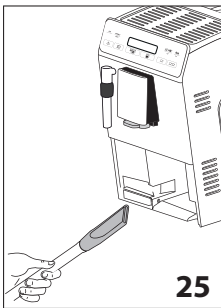
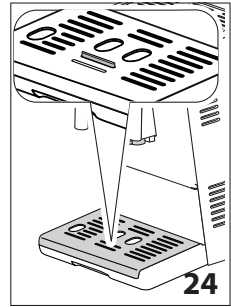
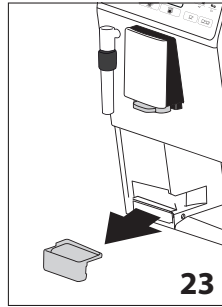
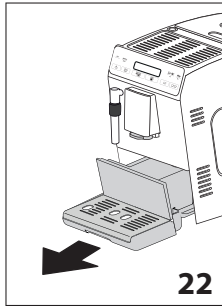
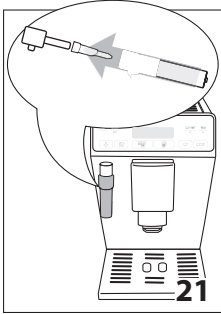
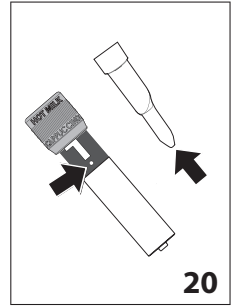
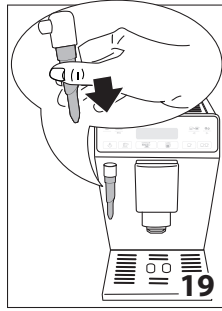
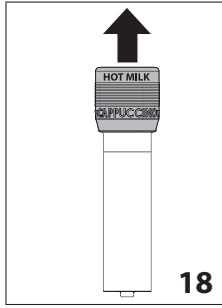
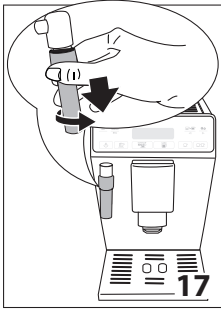

CONTENTS

1. FUNDAMENTAL SAFETY WARNINGS.....	7
2. SAFETY WARNINGS	8
2.1 Symbols used in this Instruction for Use.....	8
2.2 Designated use.....	8
2.3 Instruction for Use.....	8
3. INTRODUCTION.....	8
3.1 Letters in brackets.....	8
3.2 Troubleshooting and repairs.....	8
4. DESCRIPTION.....	9
4.1 Description of the appliance	9
4.2 Description of the touch screen.....	9
4.3 Description of the accessories.....	9
5. BEFORE USE.....	9
5.1 Checking the appliance.....	9
5.2 Installing the appliance.....	9
5.3 Connecting the appliance.....	9
5.4 Setting up the appliance.....	9
6. TURNING THE APPLIANCE ON.....	10
7. TURNING THE APPLIANCE OFF	10
8. MENU SETTINGS	10
8.1 Rinsing.....	10
8.2 Descaling	11
8.3 Install filter.....	11
8.4 Replacing the filter (if installed).....	11
8.5 Adjust time	11
8.6 Auto-start	11
8.7 Auto-off (standby)	11
8.8 Energy saving.....	11
8.9 Setting the temperature	12
8.10 Setting water hardness	12
8.11 Setting the language	12
8.12 Beep.....	12
8.13 Default values (reset)	12
8.14 Statistics function.....	12
9. MAKING COFFEE.....	12
9.1 Selecting the coffee taste.....	12
9.2 Selecting the quantity of coffee in the cup..	12
9.3 Customising the “my coffee” quantity.....	13
9.4 Adjusting the coffee mill	13
9.5 Tips for a hotter coffee.....	13
9.6 Making coffee using coffee beans	13
9.7 Making coffee using pre-ground coffee.....	13
9.8 Making DOPPIO+ coffee using coffee beans ...	14
.....	14
9.9 Customising the DOPPIO+ coffee quantity..	14
9.10 Making LONG coffee using coffee beans	14
9.11 Making LONG coffee using pre-ground coffee .	14
.....	14
9.12 Customising the LONG coffee quantity	14
10. MAKING CAPPUCCINO AND HOT MILK (FROTHED)	14
10.1 Making hot milk (not frothed).....	15
10.2 Cleaning the cappuccino maker after use....	15
11. DELIVERING HOT WATER	15
11.1 Changing the quantity of water delivered automatically	15
12. CLEANING.....	15
12.1 Cleaning the machine	15
12.2 Cleaning the machine’s internal circuit.....	16
12.3 Cleaning the coffee grounds container.....	16
12.4 Cleaning the drip tray and condensate tray..	16
12.5 Cleaning the inside of the coffee machine...	16
12.6 Cleaning the water tank.....	16
12.7 Cleaning the coffee spouts	16
12.8 Cleaning the pre-ground coffee funnel	16
12.9 Cleaning the infuser.....	16
13. DESCALING.....	17
14. SETTING WATER HARDNESS	18
14.1 Measuring water hardness.....	18
14.2 Setting water hardness	18
15. WATER SOFTENER FILTER (*CERTAIN MODELS ONLY).....	18
15.1 Installing the filter	18
15.2 Replacing the filter.....	19
15.3 Removing the filter	19
16. TECHNICAL DATA.....	19
17. DISPOSING OF THE APPLIANCE	19
18. DISPLAYED MESSAGES.....	20
19. TROUBLESHOOTING	21
20. ELECTRICAL CONNECTION (UK ONLY)	22

1. FUNDAMENTAL SAFETY WARNINGS

- Appliances can be used by persons with reduced physical, sensory or mental capabilities or lack of experience and knowledge if they have been given supervision or instruction concerning use of the appliance in a safe way and if they understand the hazards involved.
- Children shall not play with the appliance.
- Never clean by immersing the appliance in water.
- This is an household appliance only. It is not intended to be used in: staff kitchen areas in shops, offices and other working environments; farm houses; by clients in hotels, motels and other residential type environments; bed and breakfast type environments.
- If the plug or cord is damaged, it must be replaced by Customer Services only to avoid all risk.

FOR EUROPEAN MARKETS ONLY:

- Always unplug the appliance when left unattended and before assembly, taking apart or cleaning.
- This appliance shall not be used by children. Keep the appliance and its cord out of reach of children.
- Appliances can be used by persons with reduced physical, sensory or mental capabilities or lack of experience and knowledge if they have been given supervision or instruction concerning use of the appliance in a safe way and if they understand the hazards involved.
- Children shall not play with the appliance.



Surfaces marked with this symbol become hot during use (the symbol is present in certain models only).

2. SAFETY WARNINGS

2.1 Symbols used in this Instruction for Use

Important warnings are identified by these symbols. It is vital to respect these warnings.



Failure to observe the warning may result in life threatening injury by electric shock.



Failure to observe the warning could result in injury or damage to the appliance.



Failure to observe the warning could result in scalds or burns.



This symbol identifies important advice or information for the user.



This is an electrical appliance and may cause electric shock. You should therefore follow these safety warnings:

- Never touch the appliance with damp hands or feet.
- Never touch the plug with damp hands.
- Make sure the socket used is freely accessible at all times, enabling the appliance to be unplugged when necessary.
- Unplug directly from the plug only. Never pull the cord as you could damage it.
- To disconnect the appliance completely you must unplug it from the mains socket.
- If the appliance is faulty, do not attempt to repair. Turn it off, unplug from the mains socket and contact Customer Services.
- Before cleaning the appliance, turn it off, unplug from the mains socket and allow to cool.



Keep all packaging (plastic bags, polystyrene foam) away from children.



This appliance produces hot water and steam may form while it is in operation.

Avoid contact with splashes of water or hot steam.

When the appliance is in operation, the cup shelf (A6) could become very hot.

2.2 Designated use

This appliance is designed and made to prepare coffee and heat drinks.

Any other use is considered improper and thus dangerous. The manufacturer is not liable for damage deriving from improper use of the appliance.

2.3 Instruction for Use

Read this Instruction for Use carefully before using the appliance. Failure to follow this Instruction for Use may result in burns or damage to the appliance.

The manufacturer is not liable for damage deriving from failure to respect this Instruction for Use.



Keep this Instruction for Use. If the appliance is passed to other persons, they must also be provided with this Instruction for Use.

3. INTRODUCTION

Thank you for choosing this bean to cup espresso and cappuccino machine.

We hope you enjoy using your new appliance. Take a few minutes to read this Instruction for Use. This will avoid all risks and damage to the appliance.

3.1 Letters in brackets

The letters in brackets refer to the legend in the description of the appliance on pages 2-3.

3.2 Troubleshooting and repairs

In the event of problems, first try and resolve them by reading the information given in sections "18. Displayed messages" and "19. Troubleshooting".

If this does not resolve the problem or you require further information, you should consult Customer Services by calling the number given on the annexed "Customer Service" sheet.

If your country is not among those listed on the sheet, call the number given in the guarantee. If repairs are required, contact De'Longhi Customer Services only. The addresses are given in the guarantee certificate provided with the machine.

4. DESCRIPTION

4.1 Description of the appliance









(page 3 - A)

- A1. Beans container lid
- A2. Pre-ground coffee funnel lid
- A3. Beans container
- A4. Pre-ground coffee funnel
- A5.  button: turns the appliance on and off (standby)
- A6. Cup shelf
- A7. Cappuccino maker selection ring
- A8. Cappuccino maker
- A9. Cappuccino maker nozzle
- A10. Coffee spouts (adjustable height)
- A11. Condensate tray
- A12. Cup tray
- A13. Drip tray water level indicator
- A14. Drip tray
- A15. Coffee grounds container
- A16. Main switch (ON/OFF)
- A17. Power cord
- A18. Infuser door
- A19. Infuser
- A20. Water tank
- A21. Water softener filter housing
- A22. Water tank lid
- A23. Grinding adjustment dial

4.2 Description of the touch screen

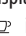
(page 2 - B)

A number of icons on the touch screen have a double function. This is indicated in brackets in the description.

- B1. **OK** icon (When in the settings menu, press to confirm the selection)
- B2.  icon: to access or exit the settings menu
- B3. Display
- B4.  icon: to select the coffee quantity (When in the settings menu, press to scroll through the menu)
- B5.  aroma selection icon: to select the coffee taste (When in the settings menu, press to scroll through the menu)
- B6.  icon: to make 2 cups of coffee with the settings displayed
- B7.  icon: to make 1 cup of coffee with the settings displayed
- B8.  icon: to make one LONG coffee
- B9.  icon: to make one DOPPIO+ coffee
- B10.  icon: to deliver hot water
- B11.  icon to deliver steam

4.3 Description of the accessories

(page 2 - C)

- C1. "Total Hardness Test" indicator paper
- C2. Pre-ground coffee measure
- C3. Descaler
- C4. Water softener filter (*certain models only)
- C5. Cleaning brush

5. BEFORE USE

5.1 Checking the appliance

After removing the packaging, make sure the product is complete and undamaged and that all accessories are present. Do not use the appliance if it is visibly damaged. Contact De'Longhi Customer Services.

5.2 Installing the appliance

Important!

When you install the appliance, you should respect the following safety warnings:

- The appliance gives off heat. After positioning the appliance on the worktop, leave a space of at least 3 cm between the surfaces of the appliance and the side and rear walls and at least 15 cm above the coffee maker.
- Water penetrating the coffee machine could cause damage.
Do not place the appliance near taps or sinks.
- The appliance could be damaged if the water it contains freezes.
Do not install the appliance in a room where the temperature could drop below freezing point.
- Arrange the cord in such a way that it cannot be damaged by sharp edges or contact with hot surfaces (e.g. electric hot plates).

5.3 Connecting the appliance

Important!

Check that the mains power supply voltage corresponds to that indicated on the rating plate on the bottom of the appliance.

Connect the appliance to an efficiently earthed and correctly installed socket with a minimum current rating of 10A only.

If the power socket does not match the plug on the appliance, have the socket replaced with a suitable type by a qualified professional.

5.4 Setting up the appliance

Please note:

- Coffee has been used to factory test the appliance and it is therefore completely normal for there to be traces of coffee.

fee in the mill. The machine is, however, guaranteed to be new.

- You should customise water hardness as soon as possible following the instructions in section "14. Setting water hardness".
1. Connect the appliance to the mains electricity supply and make sure the main switch (A16) at the back of the appliance is pressed down (fig. 1).
 2. Remove the water tank (A20) (fig. 2), open the lid (A22) (fig. 3), fill to the MAX line with fresh water, replace the lid and put the tank back in the appliance.

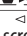
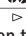
You must first choose the language by moving backwards and forwards with the  (B4) or  (B5) icon, or waiting until the languages scroll through on the display (B3) at intervals of about 3 seconds:

3. When "English" appears, press and hold the **OK** icon (B1) (fig. 4) for a few seconds until "English set" appears on the display.

Follow the instructions indicated on the appliance display:

4. "HOT WATER, Press OK": place a container with a minimum capacity of 100 ml under the cappuccino maker (A8) (fig. 5).
5. Press the **OK** icon to confirm (fig. 4). The appliance delivers water from the spout then goes off automatically.

The coffee machine is now ready for normal use.

Please note :

- The first time you use the appliance, you need to make 4-5 cups of coffee before the appliance starts to give satisfactory results.
- To enjoy your coffee even more and improve the performance of your appliance, we recommend installing a water softener filter (C4) as described in section "15. Water softener filter (*certain models only)". If your model is not provided with a filter, you can request one from De'Longhi Customer Services.

6. TURNING THE APPLIANCE ON

Please note!

- Before turning the appliance on, make sure the main switch (A16) is pressed (fig. 1).
- Each time the appliance is turned on, it performs an automatic preheat and rinse cycle which cannot be interrupted. The appliance is ready for use only after completion of this cycle.

Danger of burns!

During rinsing, a little hot water comes out of the coffee spouts (A10) and is collected in the drip tray (A14). Avoid contact with splashes of water.

- To turn the appliance on, press the  button (A5) (fig. 6). The message "Heating up Please wait" appears on the display (B3).

When heating is complete, the message changes to "Rinsing". As well as heating the boiler, this also heats the internal circuits by circulating hot water.

The appliance is at temperature when the message indicating the taste and quantity of coffee appears.

7. TURNING THE APPLIANCE OFF

Whenever the coffee machine is turned off after being used to make coffee, it performs an automatic rinse cycle.

Danger of burns!

During rinsing, a little hot water flows from the coffee spouts (A10). Avoid contact with splashes of water.

- To turn the appliance off, press the  button (A10) (fig. 6).
- The message "Turning off Please wait" appears on the display (B3), then the appliance performs a rinse cycle and goes off (standby).

Please note!

If you will not be using the appliance for some time, unplug from the mains socket:

- first turn the appliance off by pressing the  button (fig. 6);
- Press the main switch (A16) on the side of the appliance (fig. 1).

Important!

Never press the main switch while the appliance is on.

8. MENU SETTINGS

8.1 Rinsing

Use this function to deliver hot water from the coffee spouts (A10) to clean and heat the appliance's internal circuit.

Place a container with a minimum capacity of 100ml under the coffee spout.

To enable the function, proceed as follows:

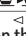
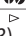
1. Press the  (B2) to enter the menu.
2. Press  (B4) or  (B5) (fig. 7) until "Rinsing" appears on the display (B3).
3. Press the **OK** icon (B1) (fig. 4) to confirm, "Confirm?" is displayed.

Important! Danger of burns.

Do not leave the appliance unattended while hot water is being delivered.

- Press the **OK** icon: after a few seconds, hot water is delivered from the coffee spouts to clean and heat the appliance's internal circuit.

i Please note!

- To stop delivery at any time, press any icon.
- If the appliance is not used for more than 3-4 days, when switched on again, we strongly recommend performing 2/3 rinses before use.

8.2 Descaling

For instructions on descaling, see section "13. Descaling".

8.3 Install filter





For instructions on how to install the filter, see section "15. Water softener filter (*certain models only)".

8.4 Replacing the filter (if installed)

For instructions on how to replace the filter, see section "15.2 Replacing the filter".

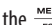
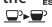
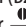
8.5 Adjust time

To adjust the time on the display (B3), proceed as follows:

- Press the  icon (B2) to enter the menu.
- Press  (B4) or  (B5) (fig. 7) until "Adjust time" is displayed.
- Press the **OK** icon (B1) (fig. 4). The hours flash on the display.
- Press  or  to change the hour.
- Press the **OK** icon to confirm. The minutes flash.
- Press  or  to change the minutes.
- Press the **OK** icon to confirm.

This sets the time. Press the  icon to exit the menu.





8.6 Auto-start

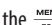

You can set the auto-start time in order to have the appliance ready at a certain time (for example in the morning) so you can make coffee immediately.

i Please note!

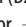
To enable this function, the time must already be set correctly.

To enable auto-start, proceed as follows:

- Press the  icon (B2) to enter the menu.
- Press  (B4) or  (B5) (fig. 7) until "Auto-start" appears on the display (B3).
- Press the **OK** icon (B1) (fig. 4). "Enable?" is displayed.
- Press the **OK** icon to confirm.
- Press  or  to choose the hour.
- Press the **OK** icon to confirm.

- Press  or  to change the minutes.

- Press the **OK** icon to confirm.

- Then press the  icon to exit the menu.

Once the time has been confirmed, activation of auto-start is indicated by the  symbol displayed alongside the time.

To disable the function:





- Select auto-start from the menu.
- Press the **OK** icon. "Disable?" is displayed.
- Press the **OK** icon to confirm.

The symbol is no longer displayed .

8.7 Auto-off (standby)

Auto-off can be set so that the appliance goes off after 15 or 30 minutes, or 1, 2 or 3 hours.

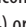
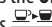
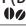
To programme Auto-off, proceed as follows:



- Press the  icon (B2) to enter the menu.
- Press  (B4) or  (B5) (fig. 7) until "Auto-off" appears on the display (B3).
- Press the **OK** icon (B1) (fig. 4).
- Press  or  until the required operating time (15 or 30 minutes, or 1, 2 or 3 hours) is displayed.
- Press the **OK** icon to confirm.
- Then press the  icon to exit the menu.

Auto-off is now programmed.

8.8 Energy saving

Use this function to enable or disable energy saving. When enabled, the function reduces energy consumption in compliance with European regulations.

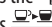
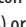
To disable (or enable) energy saving, proceed as follows:

- Press the  icon (B2) to enter the menu.
- Press  (B4) or  (B5) (fig. 7) until "Energy Saving" appears on the display (B3).
- Press the **OK** icon (B1) (fig. 4). "Disable?" is displayed (or "Enable?" if the function has been disabled).
- Press the **OK** icon to disable (or enable) energy saving mode.
- Then press the  icon to exit the menu.





When the function is active, if the machine is not used for some time, "Energy saving" is displayed.

i Please note!

- When in energy saving mode, a few seconds may elapse before the first coffee is delivered as the appliance must heat up again.
- To prepare any beverage, press any icon to exit energy saving, then press the icon corresponding to the beverage you want to make.

8.9 Setting the temperature

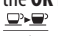
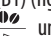
To modify the temperature of the water used to make the coffee, proceed as follows:





1. Press the  icon (B2) to enter the menu.
2. Press  (B4) or  (B5) (fig. 7) until "Set temperature" appears on the display (B3).
3. Press the **OK** icon (B1) (fig. 4).
4. Press  or  until the required temperature is displayed (●=low; ●●●●=maximum).
5. Press the **OK** icon to confirm.
6. Then press the  icon to exit the menu.

8.10 Setting water hardness

For instructions on setting water hardness, see section "14. Setting water hardness".



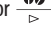
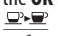
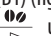

8.11 Setting the language

To modify the language of the display (B3), proceed as follows:

1. Press the  icon (B2) to enter the menu.
2. Press  (B4) or  (B5) (fig. 7) until "Set language" is displayed.
3. Press the **OK** icon (B1) (fig. 4).
4. Press  or  until the required language is displayed.
5. Press the **OK** icon to confirm.
6. A message confirming the language installed is displayed.
7. Then press the icon  to exit the menu.

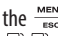
8.12 Beep



This enables or disables the beep emitted by the machine each time an icon/button is pressed, the drip tray is inserted/removed or the door is opened/closed. To disable or enable the beep, proceed as follows:

1. Press the  icon (B2) to enter the menu.
2. Press  (B4) or  (B5) (fig. 7) until "Beep" appears on the display (B3).
3. Press the **OK** icon (fig. 4). "Disable?" is displayed (or "Enable?" if the function has been disabled).
4. Press the **OK** icon to enable or disable the beep.
5. Then press the  icon to exit the menu.

8.13 Default values (reset)

This resets all menu settings and programmed quantities back to the default values (with the exception of the language which remains as set).

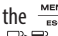



To reset the default values, proceed as follows:

1. Press the  icon (B2) to enter the menu.
2. Press  (B4) or  (B5) (fig. 7) until "Default values" appears on the display (B3).

3. Press the **OK** icon (B1) (fig. 4).
4. The message "Confirm?" is displayed.
5. Press the **OK** icon to confirm and exit.

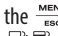
8.14 Statistics function

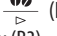
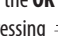
This displays statistics relating to the machine. To display the statistics, proceed as follows:

1. Press the  icon (B2) to enter the menu.
2. Press  (B4) or  (B5) (fig. 7) until "Statistics" appears on the display (B3).
3. Press the **OK** icon (B1) (fig. 4).
4. By pressing  or  you can check:
 - how many coffees have been made;
 - the total number of litres of water delivered;
 - how many times the machine has been descaled;
 - how many times the water softener filter has been replaced.
5. Press the  icon twice to exit the menu.

9. MAKING COFFEE

9.1 Selecting the coffee taste

The appliance is set by default to make coffee with a standard taste. You can also choose one of these tastes:

Extra-mild taste

Mild taste

Standard taste

Strong taste

Extra-strong taste

To change the taste, press the  icon (B5) (fig. 8) repeatedly until the required taste appears on the display (B3).

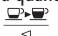

9.2 Selecting the quantity of coffee in the cup

The appliance is set by default to make a standard quantity of coffee. To select the quantity of coffee, press the  icon (B4) (fig. 9) until the message corresponding to the required quantity of coffee appears on the display (B3):

Coffee selected	Quantità in tazza (ml)
MY COFFEE	Programmable: from ≈20 to ≈180
SHORT	≈40
STANDARD	≈60
LONG	≈90
EXTRA LONG	≈120

9.3 Customising the “my coffee” quantity

The appliance is set by default to automatically deliver about 30ml of “my coffee”. To modify this quantity, proceed as follows:

1. Place a cup under the coffee spouts (A10) (fig. 10).
2. Press the  icon (B4) (fig. 9) until “MY COFFEE” is displayed.
3. Press and hold the  icon (B7) until the message “1 MY COFFEE Program quantity” appears on the display (B3) and coffee delivery begins. Release the icon.
4. As soon as the coffee in the cup reaches the required level, press the  icon again.

The quantity of coffee in the cup has now been programmed.

9.4 Adjusting the coffee mill

The coffee mill is set by default to prepare coffee correctly and should not require regulating initially.

However, if after making the first few coffees you find that the coffee is either too weak and not creamy enough or delivery is too slow (a drop at a time), this can be corrected by adjusting the grinding adjustment dial (A23) (fig. 11).



Please note!

The grinding adjustment dial must only be turned when the coffee mill is in operation.



If the coffee is delivered too slowly or not at all, turn one click clockwise towards 7. For fuller bodied creamier coffee, turn one click anticlockwise towards 1 (do not turn more than one click at a time otherwise the coffee could be delivered a drop at a time).

These adjustments will only be evident after at least 2 cups of coffee have been delivered. If this adjustment does not obtain the desired result, turn the dial another click.

9.5 Tips for a hotter coffee

For hotter coffee, you should:



- perform a rinse cycle by selecting the “Rinse” function in the settings menu (see section “8.1 Rinsing”).
- warm the cups with hot water (see section “11. Delivering hot water”).
- increase the coffee temperature in the settings menu (see section “8.9 Setting the temperature”).

9.6 Making coffee using coffee beans

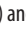

Important!

Do not use caramelised or candied coffee beans as they could stick to the coffee mill and make it unusable.

1. Fill the container (A3) (fig. 12) with coffee beans.
2. Place under the coffee spouts (A10):
 - 1 cup, if you want to make 1 coffee (fig. 10);
 - 2 cups, if you want 2 coffees (fig. 13).
3. Lower the spouts as near as possible to the cup. This makes a creamier coffee (fig. 14).
4. Press the icon corresponding to the number of coffees required (B7 - 1 cup  or B6 - 2 cups ).
5. Preparation begins. The amount of coffee selected appears on the display together with a progress bar which gradually fills as preparation progresses.

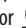

Please note:

- While the machine is making coffee, delivery can be interrupted at any moment by pressing any icon.
- At the end of delivery, to increase the quantity of coffee in the cup, within 3 seconds just press one of the coffee icons ( or ).

Once the coffee has been made, the appliance is ready to make the next drink



Important!

- Various alarm messages could be displayed while using the appliance (fill tank, empty grounds container, etc.). Their meaning is explained in section “18. Displayed messages”.
- For hotter coffee, see section “9.5 Tips for a hotter coffee”.
- If the coffee is delivered a drop at a time, too weak and not creamy enough or too cold, read the tips in section “19. Troubleshooting”.

9.7 Making coffee using pre-ground coffee





Important!

- Never place coffee beans in the pre-ground coffee funnel (A4) as this could damage the appliance.
- Never add pre-ground coffee when the machine is off or it could spread through the inside of the machine and dirty it. This could damage the appliance.
- Never use more than 1 level measure (C2) or it could dirty the inside of the coffee machine or block the funnel.



Please note!

When you use pre-ground coffee, you can only make one cup of coffee at a time.

1. Press the icon (B4) repeatedly  (B4) (fig. 8) until “Pre-ground” appears on the display (B3).
2. Open the pre-ground coffee funnel lid (A2).
3. Make sure the funnel is not blocked, then add one level measure of pre-ground coffee.
4. Place a cup under the coffee spouts (A10) (fig. 10).
5. Press the 1 cup coffee icon  (B7).

- Preparation begins. The amount of coffee selected is displayed together with a progress bar which gradually fills as preparation progresses.

i Please note!



If “Energy Saving” mode is active, you may have to wait a few seconds before the first coffee is delivered.

9.8 Making DOPPIO+ coffee using coffee beans

Follow the instructions in section “9.6 Making coffee using coffee beans” to prepare the machine and press the  icon (B9).

9.9 Customising the DOPPIO+ coffee quantity

The appliance is set by default to deliver about 120 ml of DOPPIO+ coffee. To modify these settings, proceed as follows:

- Place a sufficiently large cup or glass under the coffee spouts (A10) (fig. 10);
- Press and hold the  icon (B9) until “Program quantity” is displayed;
- Release the  icon. The appliance starts delivering coffee;
- As soon as the coffee in the cup reaches the required level, press the  icon again.

The quantity of coffee in the cup has now been programmed.

i Please note!

You can programme a minimum quantity of about 80ml.
You can programme a maximum quantity of about 160ml.

9.10 Making LONG coffee using coffee beans



Follow the instructions in section “9.6 Making coffee using coffee beans” to prepare the machine and press the  icon (B8).

9.11 Making LONG coffee using pre-ground coffee

- Follow the instructions in points 1, 2, 3 and 4 of section “9.7 Making coffee using pre-ground coffee”, then press the  icon (B8).
- The appliance starts making coffee and displays a progress bar. Halfway through preparation, the message “ADD pre-ground coffee, Press OK” appears.
- Add one level measure (C2) of pre-ground coffee and press **OK** (B1) (fig. 4).
- Preparation resumes and the appliance displays a progress bar which fills gradually as preparation proceeds.

9.12 Customising the LONG coffee quantity

The appliance is set by default to automatically deliver about 200ml of LONG coffee. To modify these settings, proceed as follows:

- Place a sufficiently large cup or glass under the coffee spouts (A10) (fig. 10).
- Press and hold the  icon (B8) until “Program quantity” is displayed.
- Release the  icon. The appliance starts delivering coffee;
- As soon as the coffee in the cup reaches the required level, press the  icon again.

The quantity of coffee in the cup has now been programmed.

i Please note!

If the programme uses pre-ground coffee, the appliance will prompt you to add a second level measure of coffee.

10. MAKING CAPPUCCINO AND HOT MILK (FROTHED)

 **Danger of burns!**

During preparation steam is given off. Take care to avoid scalds.

- When preparing cappuccino, make the coffee in a large cup.
- Fill a container (preferably one with a handle to avoid scalding) with about 100 grams of milk for each cappuccino. In choosing the size of the container, bear in mind that the milk doubles or triples in volume.

i Please note :

- For a richer denser froth, use skimmed or partially skimmed milk at refrigerator temperature (about 5°C). To avoid milk with poor froth or large bubbles, always clean the cappuccino maker (A8) as described in the section “6. Replacethe nozzle, move the selection ring downwards and put the cappuccino maker back on the nozzle (fig. 21), turning it clockwise and pushing it upwards until it is attached.”
- Make sure the cappuccino maker selection ring (A7) is positioned downwards in the “CAPPUCCINO” position (fig. 15).
 - The cappuccino maker can be turned slightly outwards to allow containers of any size to be used (fig. 16).
 - Immerse the cappuccino maker in the milk container. Never immerse the black ring.
 - Press the  icon (B11). “STEAM” appears on the display (B3).

7. After a few seconds, steam is delivered from the cappuccino maker, giving the milk a creamy frothy appearance and making it more voluminous.
8. For a creamier froth, rotate the container with slow movements in an upward direction. (You should not discharge steam for more than 3 minutes at a time).
9. When the required temperature is obtained, interrupt steam delivery by pressing the  icon.

 **Danger of burns!**

Stop steam delivery before removing the container with the frothed milk to avoid burns caused by splashes of boiling milk.

10. Add the milk froth to the coffee prepared previously. The cappuccino is ready. Sweeten to taste and, if desired, sprinkle the froth with a little cocoa powder.

 **Please note!**

If "Energy saving" is active, you may have to wait a few seconds before steam is delivered.

10.1 Making hot milk (not frothed)

To make hot milk without froth, proceed as described in the above section, but with the cappuccino maker selection ring (A7) positioned upwards in the "HOT MILK" position.

10.2 Cleaning the cappuccino maker after use

Clean the cappuccino maker (A8) each time you use it to avoid the build-up of milk residues or blockages.

 **Danger of burns!**

When cleaning the cappuccino maker, a little hot water is delivered. Avoid contact with splashes of water.

1. Deliver a little water by pressing the  con (B10). Press the same icon again to stop the flow of hot water.
2. Wait a few minutes for the cappuccino maker to cool down. Turn the cappuccino maker downwards to remove it (fig. 17).
3. Move the cappuccino/hot milk ring upwards (fig. 18).
4. Remove the nozzle downwards (A9) (fig. 19).
5. Make sure the two holes shown by the arrow in fig. 20 are not blocked. If necessary, clean with a pin.
6. Replace the nozzle, move the selection ring downwards and put the cappuccino maker back on the nozzle (fig. 21), turning it clockwise and pushing it upwards until it is attached.



11. DELIVERING HOT WATER

 **Important! Danger of burns.**

Do not leave the appliance unattended while hot water is being delivered.



 **Please note!**

If "Energy Saving" mode is active, you may have to wait a few seconds before hot water is delivered.

1. Place a container under the coffee spouts (A10) (as close as possible to avoid splashes).
2. Press the  icon (B10). "HOT WATER" appears on the display (B3), together with a progress bar which fills gradually as preparation proceeds.
3. The machine delivers about 250 ml of hot water, then delivery stops automatically. To interrupt delivery of the hot water manually, press the  icon again.

11.1 Changing the quantity of water delivered automatically

The machine is set by default to automatically deliver 250 ml of hot water. To modify these quantities, proceed as follows:

1. Position a container under the coffee spouts (A10) (fig. 5).
2. Press and hold the  icon (B10) again until "HOT WATER Program Quantity" appears on the display (B3), then release the  icon.
3. When the hot water in the cup reaches the required level, press the  icon again.

The machine is now reprogrammed with the new quantity.

12. CLEANING

12.1 Cleaning the machine

The following parts of the machine must be cleaned regularly:

- the appliance's internal circuit;
- coffee grounds container (A15);
- drip tray (A14) and condensate tray (A11);
- water tank (A20);
- coffee spouts (A10);
- cappuccino maker (A8 - "6. Replace the nozzle, move the selection ring downwards and put the cappuccino maker back on the nozzle (fig. 21), turning it clockwise and pushing it upwards until it is attached.");
- pre-ground coffee funnel (A4);
- infuser (A19), accessible after opening the infuser door (A18);

 **Important!**

- Do not use solvents, abrasive detergents or alcohol to clean the coffee machine. With De'Longhi superautomatic coffee machines, you need not use chemical products to clean the machine.
- None of the components can be washed in a dishwasher.
- Do not use metal objects to remove encrustations or coffee deposits as they could scratch metal or plastic surfaces.

12.2 Cleaning the machine's internal circuit

If the appliance is not used for more than 3/4 days, before using it again, we strongly recommend switching it on and:

- performing 2-3 rinse cycles by selecting the rinse function (see section "8.1 Rinsing");
- delivering hot water for a few seconds by pressing the  icon (B10).



Please note!

After cleaning, it is normal for the grounds container (A15) to contain water.

12.3 Cleaning the coffee grounds container

When "empty grounds container" appears on the display (B3), the grounds container must be emptied and cleaned. The appliance cannot be used to make coffee until you have cleaned the grounds container (A15). Even if not full, the empty grounds container message is displayed 72 hours after the first coffee has been prepared. For the 72 hours to be calculated correctly, the machine must never be turned off with the main switch.



Important! Danger of burns

If you make a number of cappuccinos one after the other, the metal cup tray (A12) becomes hot. Wait for it to cool down before touching it and handle from the front only.

To clean (with the machine on):

- Remove the drip tray (A14) (fig. 22), empty and clean.
- Empty the grounds container and clean thoroughly to remove all residues left on the bottom. This can be done using the spatula on the brush (C5) provided.
- Check the condensate tray (A11) and empty if necessary (fig. 23).



Important!

When removing the drip tray, the grounds container must be emptied, even if it contains few grounds. If this is not done, when you make the next coffees, the grounds container may fill up more than expected and clog the machine.

12.4 Cleaning the drip tray and condensate tray



Important!

The drip tray (A14) is fitted with a level indicator (red) (A13) showing the level of water it contains (fig. 24). Before the indicator protrudes from the cup tray (A12), the drip tray must be emptied and cleaned otherwise the water may overflow the edge and damage the appliance, the surface it rests on or the surrounding area.

To remove the drip tray:

1. Remove the drip tray and the coffee grounds container (A15) (fig. 22).

2. Empty the drip tray and grounds container and wash them.
3. Check the condensate tray (A11) and empty if necessary.
4. Replace the drip tray and grounds container.

12.5 Cleaning the inside of the coffee machine



Danger of electric shock!

Before cleaning internal parts, the machine must be turned off (see section "7. Turning the appliance off") and unplugged from the mains power supply. Never immerse the coffee machine in water.

1. Check regularly (about once a month) that the inside of the appliance (accessible after removing the drip tray (A14) is not dirty. If necessary, remove coffee deposits with the brush (C5) supplied and a sponge.
2. Remove all the residues with a vacuum cleaner (fig. 25).

12.6 Cleaning the water tank

1. Clean the water tank (A20) regularly (about once a month and whenever you replace the water softener filter (C4) (if provided) with a damp cloth and a little mild washing up liquid.
2. Remove the filter (if present) and rinse with running water.
3. Replace the filter (if provided), fill the tank with fresh water and replace the tank.
4. (Models with water softener filter only) Deliver about 100ml of hot water to reactivate the filter.

12.7 Cleaning the coffee spouts

1. Clean the coffee spouts (A10) regularly with a sponge or cloth (fig. 26).
2. Check that the holes in the coffee spouts are not blocked. If necessary, remove coffee deposits with a toothpick (fig. 26).

12.8 Cleaning the pre-ground coffee funnel

Check regularly (about once a month) that the pre-ground coffee funnel (A4) is not blocked. If necessary, remove coffee deposits with the brush (C5) supplied.

12.9 Cleaning the infuser

The infuser (A19) must be cleaned at least once a month.



Important!

The infuser may not be extracted when the machine is on.

1. Make sure the machine is correctly turned off (see section "7. Turning the appliance off").
2. Open the infuser door (A18) (fig. 27) on the right side of the appliance.

3. Press the two coloured release buttons inwards and at the same time pull the infuser outwards (fig. 28).
4. Soak the infuser in water for about 5 minutes, then rinse under the tap.



Important!

**RINSE WITH WATER ONLY
NO WASHING UP LIQUID - NO DISH WASHER**

Clean the infuser without using washing up liquid as it could be damaged.

5. Use the brush (C5) to remove any coffee residues left in the infuser housing, visible through the infuser door.
6. After cleaning, replace the infuser by sliding it onto the internal support (fig. 29), then push the PUSH symbol fully in until it clicks into place.



Please note!

If the infuser is difficult to insert, before insertion, adapt it to the right size by pressing the two levers shown in fig. 30.

7. Once inserted, make sure the two coloured buttons have snapped out (fig. 31).
8. Close the infuser door.

13. DESCALING

Descal the machine when the message “descale” flashes on the display (B3).



Important!

- Before use, read the instructions and the labelling on the descaler pack.
- You should use De'Longhi descaler only. Using unsuitable descaler and/or performing descaling incorrectly may result in faults not covered by the manufacturer's guarantee.

1. Turn the appliance on and wait until it is ready for use.
2. Press the icon (B2) to enter the menu MENU DESC (B2).
3. Press (B4) or (B5) (fig. 7) until “Descale” is displayed.
4. Select by pressing the **OK** icon (B1) (fig. 4): the message “Descaling Confirm?” is displayed.
5. Press the **OK** icon again to confirm. “EMPTY DRIP TRAY” is displayed, alternating with “REMOVE FILTER” (if the filter is present) and “Add descaler, Press OK”.
6. Empty the water tank (A20) completely and remove the water softener filter (C4), if present. Empty the drip tray (A14 - fig. 22) and grounds container (A15), then put them back in the appliance.

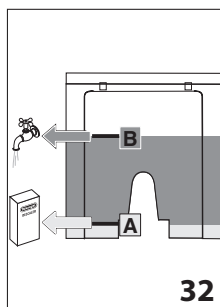

7. Pour the descaler (C3) into the tank up to level A (corresponding to a 100 ml pack) marked on the back of the tank (fig. 32), then add a litre of water up to level B (fig. 32) and put the water tank back in the appliance.

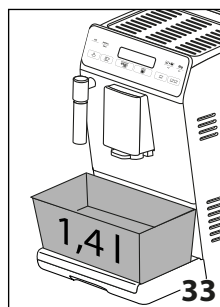

8. Place an empty container with a minimum capacity of 1.4 litres under the coffee spouts (A10) and cappuccino maker (A8) (fig. 33).



Important! Danger of burns

Hot water containing acid flows out of the cappuccino maker.

Take care to avoid contact with splashes of this solution

9. Press the **OK** icon to confirm that you have added the descaler solution. The message “Descale underway” is displayed and the descaling procedure begins. The descaler liquid comes out of the coffee spouts and cappuccino maker and a series of rinses and pauses is performed to remove limescale deposits from inside the machine. After about 25 minutes, descaling stops and the messages “RINSING” and “FILL TANK” alternate on the display.
10. The appliance is now ready for rinsing through with clean water. Empty the container used to collect the descaler solution. Extract the water tank, empty, rinse under running water, fill with fresh water up to the MAX level and put back in the appliance: “RINSING, Press OK” is displayed.
11. Place the container used to collect the descaler solution empty under the coffee spouts and cappuccino maker (fig. 33).
12. Press the **OK** icon to begin rinsing. Hot water is delivered first from the coffee spouts to continue and end with the cappuccino maker. The message “RINSING Please wait” appears on the display.
13. When the water tank is empty, the messages “RINSING”, “FILL TANK” and “REPLACE FILTER” (if previously removed) alternate on the display. Empty the container used to collect the rinsing water.
14. Remove the water tank, replace the water softener filter (if previously removed), fill the tank up to the MAX level with

fresh water and insert it in the appliance. "RINSING Press OK" will appear on the display.

15. Place the container used to collect the rinsing water empty under the cappuccino maker (fig. 33).
 16. Press the **OK** icon to resume rinsing. Hot water is delivered from the cappuccino maker only and the message "RINSING Please wait" is displayed.
 17. When it finishes, the message "Rinsing complete, Press OK" is displayed.
 18. Press the **OK** icon. The message "FILL TANK" is displayed. Remove and top up the water tank with fresh water to the MAX level and put back in the machine.
 19. Empty the drip tray.
- Descaling is complete.

i Please note!

- If the descaling cycle is not completed correctly (e.g. no electricity) we recommend repeating the cycle;
- After descaling, it is normal for the grounds container (A15) to contain water.

14. SETTING WATER HARDNESS

The DESCAL message is displayed after a period of time established according to water hardness.

The machine is set by default for a hardness value of 4. The machine can also be programmed according to the hardness of the mains water in the various regions so that the machine needs to be descaled less often.

14.1 Measuring water hardness

1. Remove the "TOTAL HARDNESS TEST" indicator paper (C1) from its pack (attached to the English instructions).
2. Immerse the paper completely in a glass of water for one second.
3. Remove the paper from the water and shake lightly. After about a minute, 1, 2, 3, or 4 red squares form, depending on the hardness of the water. Each square corresponds to one level.

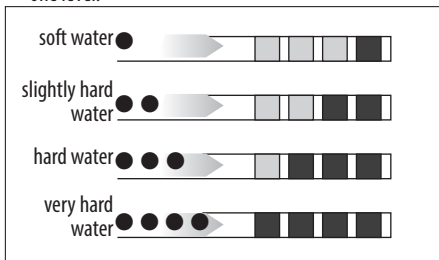

14.2 Setting water hardness

1. Press the **MENU ESC** icon (B2) to enter the menu.

2. Press **☰** (B4) or **☱** (B5) (fig. 7) and select "Water hardness".
3. Confirm the selection by pressing the **OK** icon (B1) (fig. 4).
4. Press **☰** or **☱** repeatedly to set the level as measured by the indicator paper (see previous section).
5. Press the **OK** icon to confirm the setting.
6. Press the **MENU ESC** icon to exit the menu.

The machine is now reprogrammed with the new water hardness setting.

15. WATER SOFTENER FILTER (*CERTAIN MODELS ONLY)

Certain models are fitted with a water softener filter (C4). If this is not the case with your model, you are recommended to purchase one from De'Longhi Customer Services.

To use the filter correctly, follow the instructions below.

15.1 Installing the filter

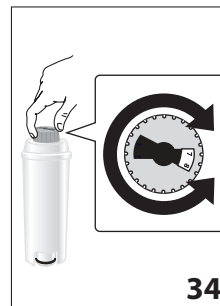

1. Remove the filter (C4) from the packaging.
2. Turn the date indicator disk (see fig. 34) until the next 2 months of use are displayed.

i Please note

The filter lasts about two months if the appliance is used normally. If the coffee machine is left unused with the filter installed, it will last a maximum of

three weeks.

3. To activate the filter, run tap water through the hole in the filter as shown in the figure until water comes out of the openings at the side for more than a minute (fig. 35).

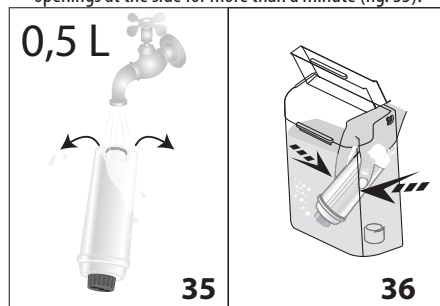

4. Extract the tank (A20) from the appliance and fill with water.

- Insert the filter in the water tank and immerse it completely for about ten seconds, sloping it and pressing it lightly to enable the air bubbles to escape (fig. 37).
- Insert the filter in the filter housing (A21) (fig. 36) and press as far as it will go.
- Close the tank with the lid (A22) (fig. 38), then replace the tank in the machine.

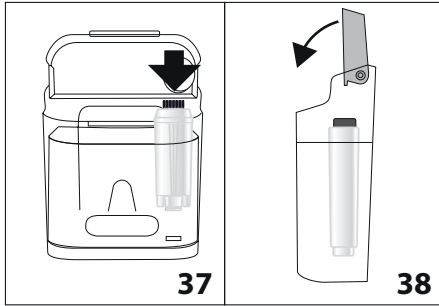

When you install the filter, you must notify the appliance of its presence.

- Press the **MENU ESC** icon (B2) to enter the menu;
- Press (B4) or (B5) until "Install filter" appears on the display (B3).
- Press the **OK** icon (B1) (fig. 4).
- "Enable?" is displayed.
- Press the **OK** icon to confirm the selection. "HOT WATER Press OK" is displayed.
- Place a container underneath the cappuccino maker (A8) (min. capacity: 500ml) (fig. 5).
- Press the **OK** icon to confirm the selection. The appliance begins hot water delivery and the message "Please wait" is displayed.
- After the flow of hot water stops, the appliance automatically resets to "Ready for coffee" status.

The filter is now active and you can use the coffee machine.

15.2 Replacing the filter

When "REPLACE FILTER" appears on the display (B3), after two months (see date indicator) or when the appliance has not been used for 3 weeks, you should replace the filter:

- Extract the tank (A20) and exhausted filter (C4).
- Take the new filter out of its packet and proceed as illustrated in points 2, 3, 4, 5, 6 and 7 in the previous section.
- Place a container underneath the cappuccino maker (min. capacity: 500ml).
- Press the **MENU ESC** icon (B2) to enter the menu;
- Press (B4) or (B5) (fig. 7) until "Replace filter" is displayed.
- Press the **OK** icon (fig. 4).
- The message "Confirm?" is displayed.

- Press the **OK** icon to confirm the selection.
- "HOT WATER Press OK" is displayed.
- Press the **OK** icon to confirm the selection. The appliance begins hot water delivery and the message "Please wait" is displayed.
- After the flow of hot water stops, the appliance automatically resets to "Ready for coffee" status.

The new filter is now active and you can use the coffee machine.

15.3 Removing the filter

If you want to use the appliance without the filter, you must remove it and notify the appliance of its removal. Proceed as follows:

- Remove the tank (A20), remove the filter (C4) and put the tank back in the appliance.
- Press the **MENU ESC** icon (B2) to enter the menu.
- Press (B4) or (B5) (fig. 7) until "Install filter, Enabled" appears on the display (B3).
- Press the **OK** icon (B1) (fig. 4).
- "Disable?" appears on the display.
- Press the **OK** icon to confirm and the **MENU ESC** icon to exit the menu.

16. TECHNICAL DATA

Voltage:	220-240 V~ 50/60 Hz max. 10A
Absorbed power:	1450W
Pressure:	1,5MPa (15 bar)
Max. water tank capacity:	1,4 l
Size LxDxH:	195x480x340 mm
Cord length:	1100 mm
Weight:	9,3 kg
Max. beans container capacity:	200 g

The appliance complies with the following EC directives:

- European Standby Regulation 1275/2008
- Materials and accessories coming into contact with food conform to EEC regulation 1935/2004.

17. DISPOSING OF THE APPLIANCE



The appliance must not be disposed of with household waste, but taken to an authorised waste separation and recycling centre.

18. DISPLAYED MESSAGES

DISPLAYED MESSAGE	POSSIBLE CAUSE	REMEDY
FILL TANK	Insufficient water in the tank (A20).	Fill the tank with water and/or insert it correctly, pushing it as far as it will go until it clicks into place.
EMPTY GROUNDS CONTAINER	The grounds container (A15) is full.	Empty the grounds container and drip tray (A14), clean and replace. Important: when removing the drip tray, the grounds container must be emptied, even if it contains few grounds. If this is not done, when you make the next coffees, the grounds container may fill up more than expected and clog the machine.
GROUND TOO FINE ADJUST MILL	The grinding is too fine and the coffee is delivered too slowly or not at all.	Repeat coffee delivery and turn the grinding adjustment dial (A23) (fig. 11) one click clockwise towards 7 while the coffee mill is in operation. If after making at least 2 coffees delivery is still too slow, repeat the correction procedure, turning the grinding adjustment dial another click until delivery is correct (see section "9.4 Adjusting the coffee mill"). If the problem persists, make sure the water tank (A20) is fully inserted.
	If the water softener filter (C4) is present, an air bubble may have been released inside the circuit, obstructing delivery.	Deliver a little water until the flow becomes regular.
INSERT GROUNDS CONTAINER	After cleaning, the grounds container (A15) has not been replaced.	Remove the drip tray (A14) and insert the grounds container.
ADD PRE-GROUND COFFEE	The "pre-ground coffee" function has been selected without placing any pre-ground coffee in the funnel (A4).	Place pre-ground coffee in the funnel (A4) or deselect the pre-ground function.
DESCALE	The machine must be descaled.	The descaling procedure described in section "13. Descaling" needs to be performed.
LESS COFFEE	Too much coffee has been used.	Select a milder taste by pressing the  icon (B4) (fig. 8) or reduce the quantity of pre-ground coffee.
FILL BEANS CONTAINER	The coffee beans have run out.	Fill the beans container (A3) (fig. 12).
	The pre-ground coffee funnel (A4) is clogged.	Empty the funnel with the help of the brush (C5) as described in section "12.8 Cleaning the pre-ground coffee funnel".
INSERT INFUSER ASSEMBLY	The infuser (A19) has not been replaced after cleaning.	Insert the infuser as described in section "12.9 Cleaning the infuser".
GENERAL ALARM	The inside of the appliance is very dirty.	Clean the inside of the appliance thoroughly, as described in section "13. Descaling". If the message is still displayed after cleaning, contact a service centre.

WATER CIRCUIT EMPTY FILL WATER CIRCUIT HOT WATER Press OK	The water circuit is empty.	Press OK (B1) and deliver water from the cappuccino maker (A8) until it flows out normally. If the problem persists, make sure the water tank (A20) is fully inserted.
REPLACE FILTER	The water softener filter (C4) is exhausted.	Replace the filter or remove it as described in section "15. Water softener filter (*certain models only)".

19. TROUBLESHOOTING

Below is a list of some of the possible malfunctions.

If the problem cannot be resolved as described, contact Customer Services.

PROBLEM	POSSIBLE CAUSE	REMEDY
The coffee is not hot.	The cups were not preheated.	Warm the cups by rinsing them with hot water (Please note: you can use the hot water function).
	The internal circuits of the appliance have cooled down because 2/3 minutes have elapsed since the last coffee was made.	Before making coffee, heat the infuser by performing a rinse cycle (see section "8.1 Rinsing").
	A low coffee temperature is set.	Set a higher coffee temperature in the menu (section "8.9 Setting the temperature").
The coffee is weak or not creamy enough.	The coffee is ground too coarsely.	Turn the grinding adjustment dial (A23) one click anticlockwise towards 1 while the coffee mill is in operation (fig. 11). Continue one click at a time until coffee delivery is satisfactory. The effect is only visible after delivering 2 coffees (see section "9.4 Adjusting the coffee mill").
	The coffee is unsuitable.	Use pre-ground coffee for espresso machines.
The coffee is delivered too slowly or a drop at a time.	The coffee is ground too finely.	Turn the grinding adjustment dial (A23) one click clockwise towards 7 while the coffee mill is in operation (fig. 11). Continue one click at a time until coffee delivery is satisfactory. The effect is only visible after delivering 2 coffees (see section "9.4 Adjusting the coffee mill").
Coffee does not come out of one or both of the spouts.	The coffee spouts (A10) are blocked.	Clean the spouts with a toothpick (fig. 26).
The appliance does not come on	It is not plugged into the mains socket.	Plug into the mains socket.
	The main switch (A16) is not turned on.	Press the main switch (fig. 1).
The infuser cannot be extracted	The appliance has not been turned off correctly	Turn the appliance off by pressing the  button (section "7. Turning the appliance off").
The frothed milk has large bubbles	The milk is not cold enough or is not semi-skimmed.	You should ideally use skimmed or semi-skimmed milk at refrigerator temperature (about 5°C). If the result is not as you wished, try changing brand of milk.

The milk is not frothed	The cappuccino maker (A8) is dirty.	Clean the cappuccino maker as described in section "10.2 Cleaning the cappuccino maker after use".
	The ring on the cappuccino maker (A7) is in the "HOT MILK" position.	Push the ring into the "CAPPUCCINO" position (fig. 15).
Steam delivery stops	A safety device stops steam delivery after 3 minutes.	Wait a few minutes and then enable the steam function again.

20. ELECTRICAL CONNECTION (UK ONLY)

Before using this appliance ensure that the voltage indicated on the product corresponds with the main voltage in your home, if you are in any doubt about your supply contact your local electricity company.

The flexible mains lead is supplied connected to a B.S. 1363 fused plug having a fuse of 13 amp capacity.

Should this plug not fit the socket outlets in your home, it should be cut off and replaced with a suitable plug, following the procedure outlined below.

Note: Such a plug cannot be used for any other appliance and should therefore be properly disposed of and not left where children might find it and plug it into a supply socket - with the obvious consequent danger.

Please note: We recommend the use of good quality plugs and wall sockets that can be switched off when the machine is not in use.

IMPORTANT: The wires in the mains lead fitted to this appliance are coloured in accordance with the following code:

GREEN AND YELLOW
BLUE
BROWN

EARTH
NEUTRAL
LIVE

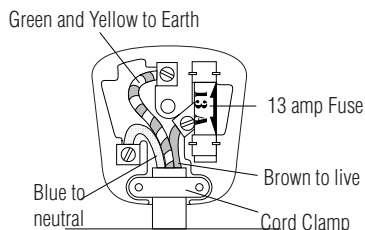

As the colours of the wires in the mains lead of this appliance may not correspond with the coloured markings identifying the terminals in your plug, proceed as follows:

- The wire which is coloured green and yellow must be connected to the terminal in the plug which is marked with the letter E or by the earth symbol \perp or coloured green or green and yellow.
- The wire which is coloured blue must be connected to the terminal which is marked with the letter N or coloured black.
- The wire which is coloured brown must be connected to the terminal which is marked with the letter L or coloured red.

When wiring the plug, ensure that all strands of wire are securely retained in each terminal. Do not forget to tighten the mains lead clamp on the plug. If your electricity supply point has only two pin socket outlets, or if you are in doubt, consult a qualified electrician.

Should the mains lead ever require replacement, it is essential that this operation be carried out by a qualified electrician and should only be replaced with a flexible cord of the same size.

After replacement of a fuse in the plug, the fuse cover must be refitted. If the fuse cover is lost, the plug must not be used until a replacement cover is obtained. The colour of the correct replacement fuse cover is that of the coloured insert in the base of the fuse recess or elsewhere on the plug. Always state this colour when ordering a replacement fuse cover.

Only 13amp replacement fuses which are asta approved to B.S. 1362 should be fitted.

This appliance conforms to the Norms EN 55014 regarding the suppression of radio interference.

Warning - this appliance must be earthed