

Proudly distributed by  
**De'Longhi Australia Pty Limited**  
P.O. BOX 4540  
CASULA MALL NSW 2170  
Customer Service Ph: 1800 126 659  
Fax: 1800 706932  
[www.delonghi.com.au](http://www.delonghi.com.au)  
e-mail: [delonghi@delonghi.com.au](mailto:delonghi@delonghi.com.au)

**De'Longhi New Zealand Limited**  
25 Carbine Road  
Mt Wellington  
Auckland, New Zealand  
P.O. Box 58-056 Botany  
MANUKAU 2163  
Customer Service Ph: 0508 200 300  
Fax: 0508 200 301  
[www.delonghi.com.nz](http://www.delonghi.com.nz)  
e-mail: [delonghi@delonghi.com.nz](mailto:delonghi@delonghi.com.nz)

---

TRD4 Series

DRAGON 4 OIL FILLED RADIATOR  
Instructions for use



---

**DeLonghi**

**DESCRIPTION**

---

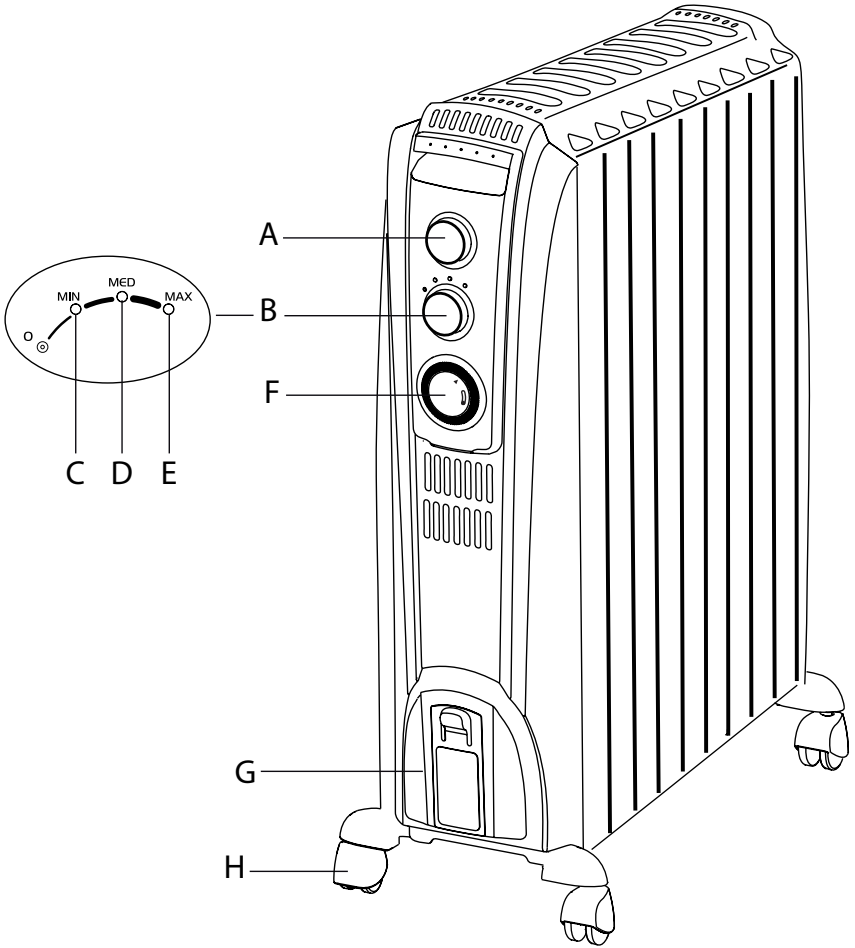

## INSTRUCTIONS FOR USE

Read these instructions carefully before using the appliance. Failure to comply with these instructions can lead to injury to persons and damage to the machine. The manufacturer is not liable for damage deriving from the failure to comply with the user instructions.

### Symbols used in these instructions

Important warnings are identified by the symbols below.

It is important to respect the warnings. Failure to respect the warnings could lead to electric shock, serious injury, burns, fire or damage to the appliance.



**Danger!**

Failure to observe the warning may result in life threatening injury by electric shock.



**Important!**

Failure to observe the warning could result in injury or damage to the appliance.



**Danger of burns!!**

Failure to observe the warning could result in burns or scalds.



**Please note:**

This symbol indicates recommendations and important information for the user.

## SAFETY WARNINGS



**Danger!**

As the appliance operates using electricity, electric shocks can not be excluded.

Therefore, follow the safety recommendations given:

- To avoid risk of cable overheating, extension leads must not be used in powering this appliance.
- If the power cable is damaged, it must be replaced by the manufacturer or an authorised service centre in order to eliminate all risk. Please contact Customer Experience, see enclosed guarantee.
- Do not use the heater in a bathroom or in the vicinity of bathtubs, washbasins, showers or swimming pools.



**Important!**

- The appliance is not intended for use by persons (including children) with reduced physical, sensory or mental capabilities, or lack of experience and knowledge, unless they have been given supervision or instruction concerning

use of the appliance by a person responsible for their safety. Children should be supervised to ensure that they do not play with the appliance.

- The heater must be positioned at least 50cm from furniture or other objects.
- Do not use this appliance in rooms measuring less than 4m<sup>2</sup>.
- Do not place items over the radiator (such as to dry washing).
- In order to avoid a hazard due to inadvertent resetting of the thermal cutout, this appliance must not be supplied through an external switching device such as a timer, or connected to a circuit that is regularly switched on and off by the utility.



**Danger of burns!!**

- Do not rest the power cable on hot elements.



**WARNING:** In order to avoid overheating, never under any circumstances cover the appliances during operation, as this would lead to dangerous overheating.



**Please note:**

- The appliance must not be placed immediately under a fixed power socket.
- The power cord should be fully removed from the cord storage unit when in use.
- The appliance is fitted with a tilt-switch which turns the appliance off if it should fall over. To restart the appliance, simply place it upright again.
- Always use the radiator in the vertical position.
- When you turn the appliance on for the first time, operate it at maximum for at least two hours.
- It is normal for the appliance to make "creaking" noises when first turned on.
- In order to eliminate the radiator's "new" smell, set it to maximum power for at least a few hours when used for the first time. During this operation, the room in which the radiator is located must be ventilated.
- This appliance is filled with a precise quantity of oil and repairs requiring it to be opened must be carried out by the manufacturer or an authorised technical assistance centre only. In the event of oil leaks, please contact Customer Experience, see enclosed guarantee.
- As with any electrical appliance, whilst the instructions aim to cover as many eventualities as possible, caution and common sense should be applied when operating your

appliance, particularly in the vicinity of young children.

- A safety device will turn the radiator off. To reset, contact the technical assistance service.

### Use in compliance with intended use

Use this heater only as described in this manual. All other use is considered improper. This appliance is not suitable for commercial use. The manufacturer is not liable for damage deriving from improper use of the appliance. This is a household appliance only. It is not intended to be used in:

- staff kitchen areas in shops, offices and other working environments;
- farm houses;
- by clients in hotels, motels and other residential type environments;
- bed and breakfast type environments.

Use in this manner will invalidate the manufacturer's warranty.

### Introduction

Thank you for choosing the TRD Oil Filled Radiator. We hope you enjoy using your new appliance. Take a few minutes to read these instructions. This will avoid all risks and damage to the appliance.

### DESCRIPTION

(see figure on pag. 2).

The terminology below will be used repeatedly in the following pages.

- A** Thermostat
- B** Power selector
- C/D/E** Power indicator lights (MIN, MED, MAX)
- F** Timer
- G** Cord holder
- H** Wheel

### USE

#### Fitting the wheels

Turn the radiator upside down on a rug or soft surface to prevent damaging the paint finish. Fully unfold the wheels by turning them outwards (Fig. 1). Turn the radiator back to its upright position.

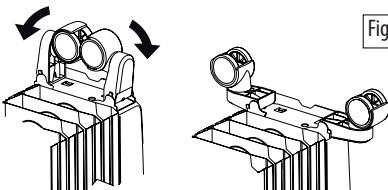

### Caution

Always operate the heater in upright position only (wheels on the bottom, controls on top).

Any other position could create a hazardous situation.

### Location

The heater should not be placed immediately below a power outlet. Do not use this radiator in rooms with a floor area of less than 4 m<sup>2</sup> (43 sq. ft.).

### Connection

- Before using the appliance check that your supply voltage is the same of that shown on the rating label of the unit and that the power socket and power supply line correspond to the load specified.
- Check also the current capacity of your fuses. **CONNECT YOUR HEATER TO EARTH PROVIDED SOCKET ONLY.**
- This appliance complies with directive 2004/108/ec on electromagnetic compatibility.

Keep loose clothing or bedding, furniture and flammable material away from the heater's wall outlet.

### Turning on

Insert the plug into an electrical outlet, rotate the thermostat knob to maximum and turn the unit on as follows using the power selector:

- Turn the power selector to position MIN to select minimum output (the min light will be on).
- Turn the power selector to position MED to select medium output (the min/med light will be on).
- Turn the power selector to position MAX to select maximum output (the lights will be on).

### Adjusting the thermostat

When the room has reached the desired temperature, turn the thermostat knob slowly in an anti-clockwise direction until you hear a "click" and not beyond it. The thermostat will then adjust the set temperature automatically and keep it constant.

If your unit is a three-output version, in intermediate seasons or on days when temperatures are not particularly cold, select minimum output to optimize savings and consumption.

### Antifreeze function

Turn the thermostat dial to the ❄️ position and the power selector to position MAX. The appliance will maintain a minimum room temperature of approximately 5°C, thus preventing freezing while conserving energy. In models that come with a timer, tabs must be set in the inward position.

**Reminder**

To completely shut the appliance off, turn the power selector to the "0" position and then unplug the appliance from the outlet.

**UNITS WITH TIMER**

**How to use the timer**

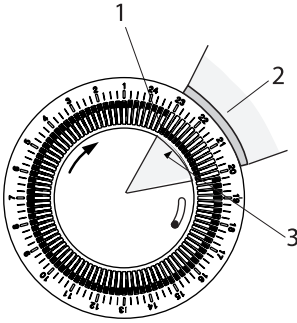

To program heating, proceed as follows:

- Look at the time on your clock or watch. If it is 10 p.m., turn the numbered timer disk clockwise until the number 22 (10 p.m.) on the disk coincides with the pointer ▲ (3) on the timer. Set the periods of time when you want the appliance to work by pushing the teeth (1) inward. Each tooth (1) corresponds to a period of 15 minutes. This will leave visible sectors which correspond to the periods of operation (2). When set, the radiator will operate automatically each day during the times programmed (important: the radiator must always be plugged into the socket).
- To change the programming, move the teeth back into the initial position and set the new periods of operation.
- To turn the appliance off completely, as well as turning the knob to the off position, you must also unplug it from the power outlet to avoid continued operation of the timer.

**IMPORTANT: DO NOT ROTATE CLOCK DIAL COUNTER-CLOCKWISE.**

**TROUBLESHOOTING**

| PROBLEM                    | CAUSE   | SOLUTION   |
|----------------------------|---|--|
| The appliance doesn't work | Be sure it is plugged in and that the electrical outlet is working.<br>Check for any obstruction. | Plug into the power outlet.<br><br>Remove the obstruction and let the appliance cool down. If the appliance doesn't work please contact Customer Experience. |
|                            | The temperature may be set too low.   | Set the temperature to a higher position.  |

The timer is like an electric clock, and will only work when plugged into a power supply. When unplugged, the timer stops and must be later re-set.

**Timer override**

If you wish to override the timer settings, push the timer switch to position I (fig.2) manual (timer override). To return to timed operation push the switch back to the middle position ⓐ (fig.2).

**NOTE: if the timer switch is at the 0 position (fig. 2), the heater is off and will not operate).**

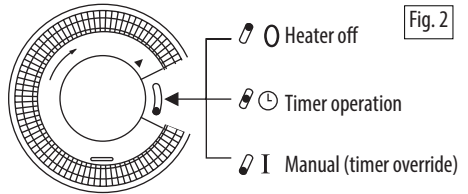

**Safety device**

A safety device shuts the radiator down in the case of overheating. To start the radiator up again, contact Customer Experience. See enclosed guarantee leaflet.

**MAINTENANCE AND SERVICE**

Always unplug the heater from the power outlet and allow the radiator to cool. Wipe radiator with a soft damp cloth; do not use detergents or abrasives. Should the radiator not be in use over a certain length of time, wind the cord around the holder and store it in a dry place. This appliance has been built to last for many years of trouble-free service. In case of malfunction or doubt, do not try to repair the heater by yourself: this might increase the risk of fire and electric shock. Please refer to the enclosed guarantee leaflet for service and assistance details.